

REVISION HISTORY			
REV	DATE	BY	DESCRIPTION
A	12AUG2015	IGS/DAG	PRN: P2015-1623

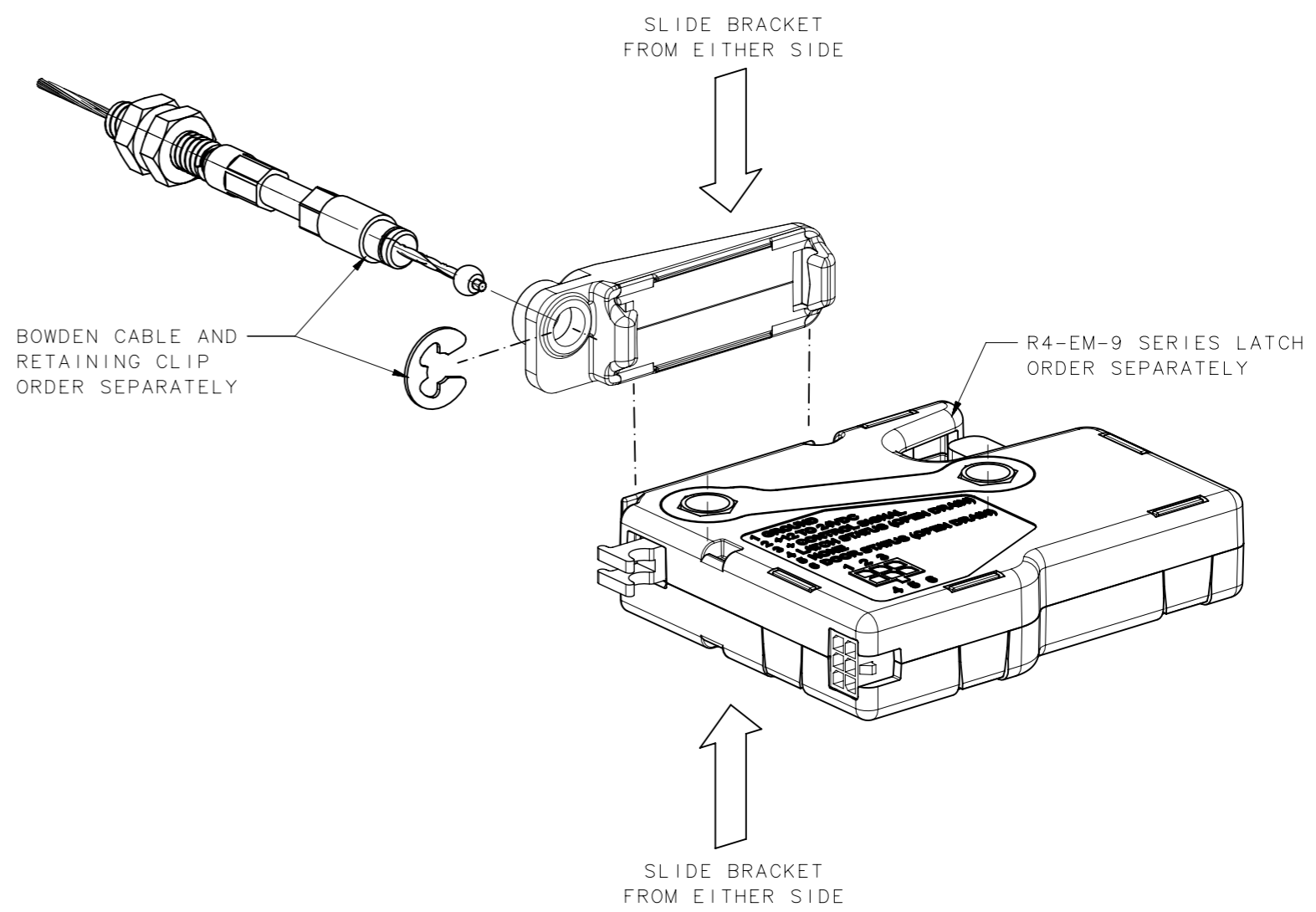
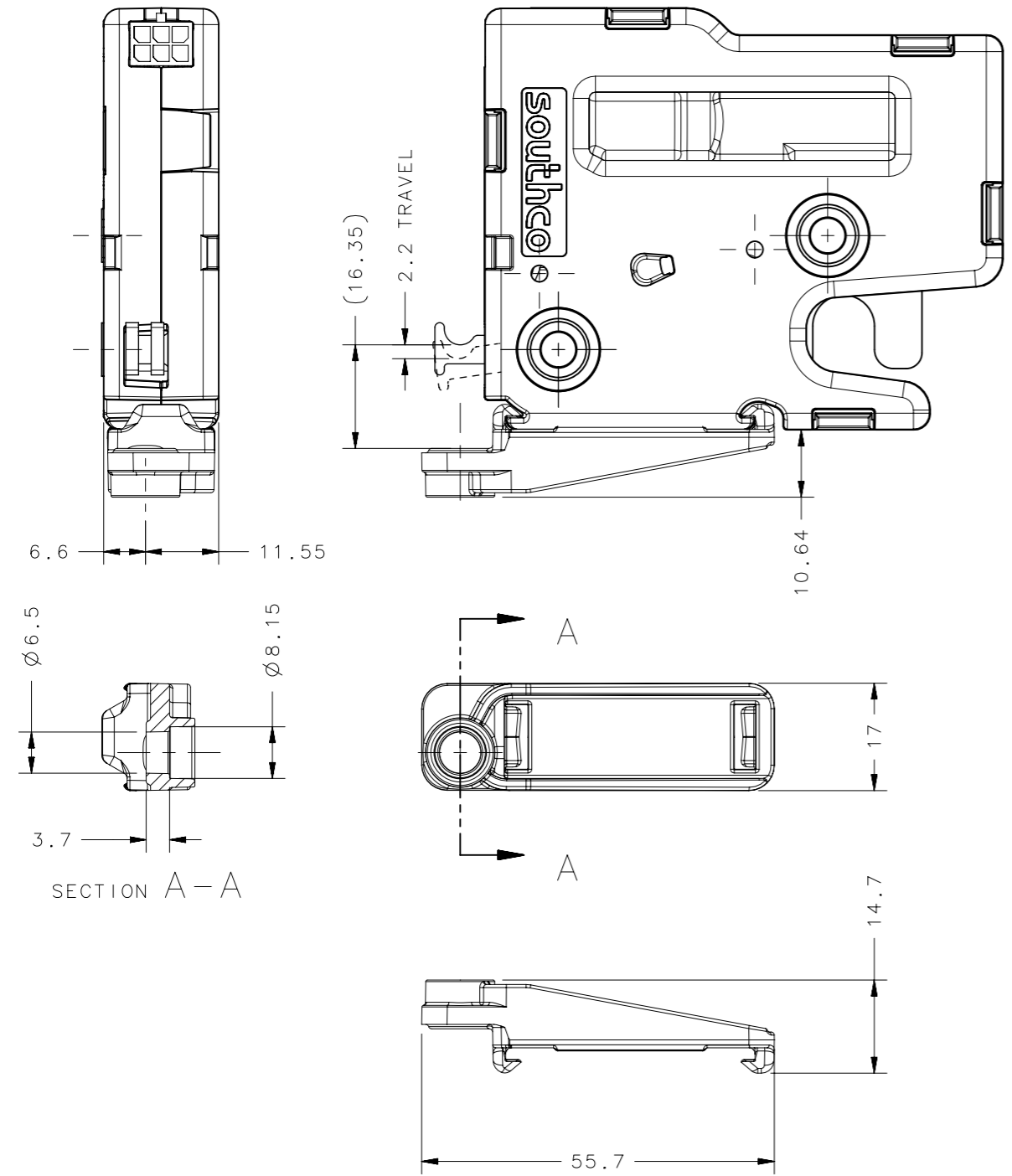

- NOTES:
1. THE R4-EM-952 BRACKET ALLOWS A MECHANICAL OVERRIDE CABLE SYSTEM TO BE ATTACHED TO THE R4-EM-9 SERIES FAMILY OF LATCHES.
  2. BRACKET IS INTENDED FOR USE WITH CABLES HAVING 6.35MM (0.25") SNAP RING CONDUIT FITTINGS.
  3. CONTACT SOUTHCO FOR AVAILABLE CABLE OPTIONS.
  4. INSTALLATION:
    - FEED THE CABLE END THROUGH THE HOLE IN THE MANUAL OVERRIDE BRACKET IN THE DIRECTION SHOWN.
    - SNAP THE RETAINING CLIP OVER THE CABLE (SLIDE IN THE GROOVE ON THE CABLE END) TO SECURE THE CABLE TO THE BRACKET.
    - SLIDE THE BRACKET ONTO THE LATCH FROM EITHER SIDE UNTIL CENTERED OVER THE WIDTH OF THE LATCH.
    - SLIDE BALL END OF CABLE OUT AND SLIP WIRE INTO NOTCH OF MANUAL OVERRIDE TRIGGER.
    - VERIFY THE R4-EM TRIGGER IS FREE TO MOVE WHEN OPERATED ELECTRICALLY AND RETURNS TO THE FULLY LOCKED POSITION.

R4-EM-952	BRACKET	PA-GF BLACK	N/A	N/A
PART NUMBER	TYPE OF COMPONENT	MATERIAL	HEAT TREAT	FINISH
THIRD ANGLE PROJECTION				
MILLIMETERS [IN]				
TOLERANCES UNLESS OTHERWISE NOTED		DESCRIPTION		
SURFACE AREA 3465.56mm <sup>2</sup>		MANUAL OVERRIDE BRACKET		
VOLUME 3337.82mm <sup>3</sup>		ALL DIMENSIONS WITHOUT TOLERANCES ARE FOR REFERENCE ONLY.		
PROPRIETARY ITEM		SIZE A3	SYSTEM NX	DWG NO. J-R4-EM-952
EXCEPT FOR USES EXPRESSLY GRANTED IN WRITING, INFORMATION DISCLOSED HEREON IS CONFIDENTIAL AND ALL RIGHTS, PATENT AND OTHERWISE, ARE RESERVED BY SOUTHCO, INC.		PER ASME Y14.5M-1994	DRAWN BY IGS/MGG	DATE 10AUG2015
		SCALE 1:1	SHEET 1 OF 1	