

| REVISION HISTORY | | | |
|------------------|-----------|---------|-----------------|
| REV | DATE | BY | DESCRIPTION |
| K | 29JUN2016 | AVC/NJF | PRN: P2016-1614 |

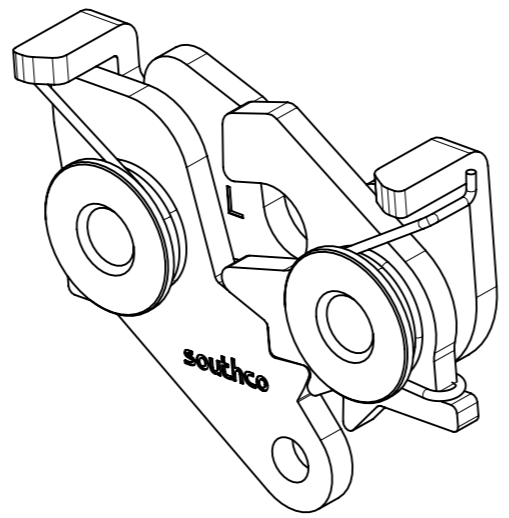

2X $\varnothing 6.5$ IF USING M6 SCREW
 2X H-SIZE DRILL IF USING 1/4 SCREW
 (FOR THROUGH HOLE MOUNTING)

HOLES FOR OPTIONAL MOUNTING BRACKET FOR DETAILS SEE J-AC-900-002-10

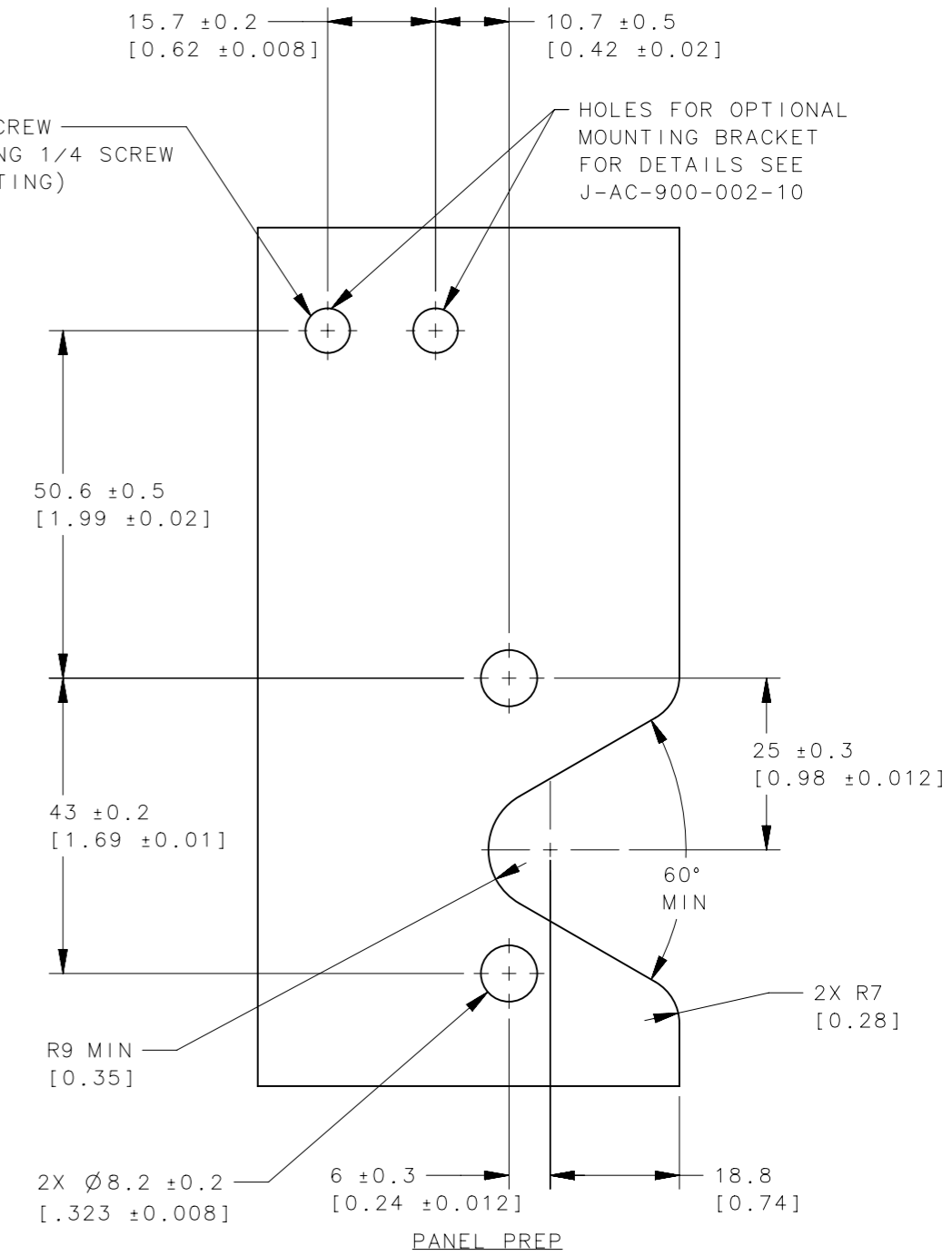
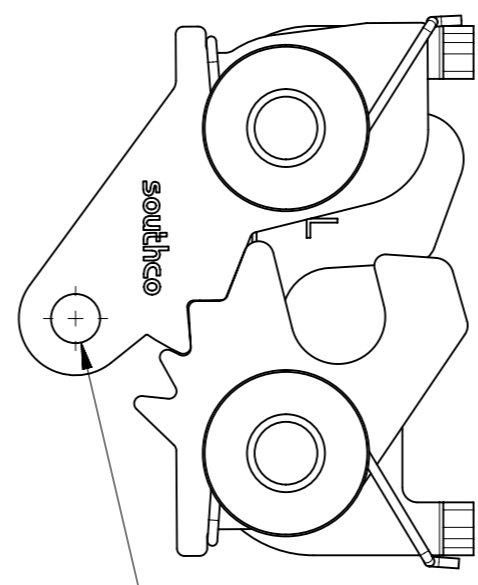
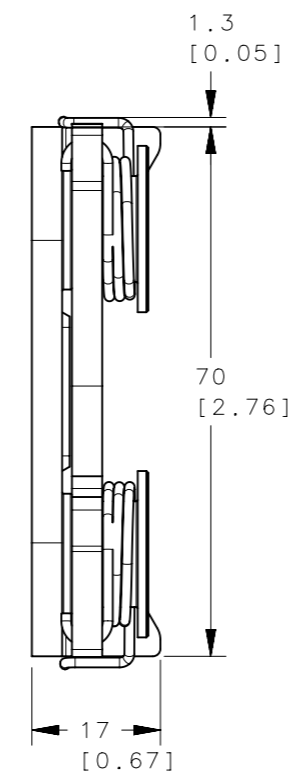
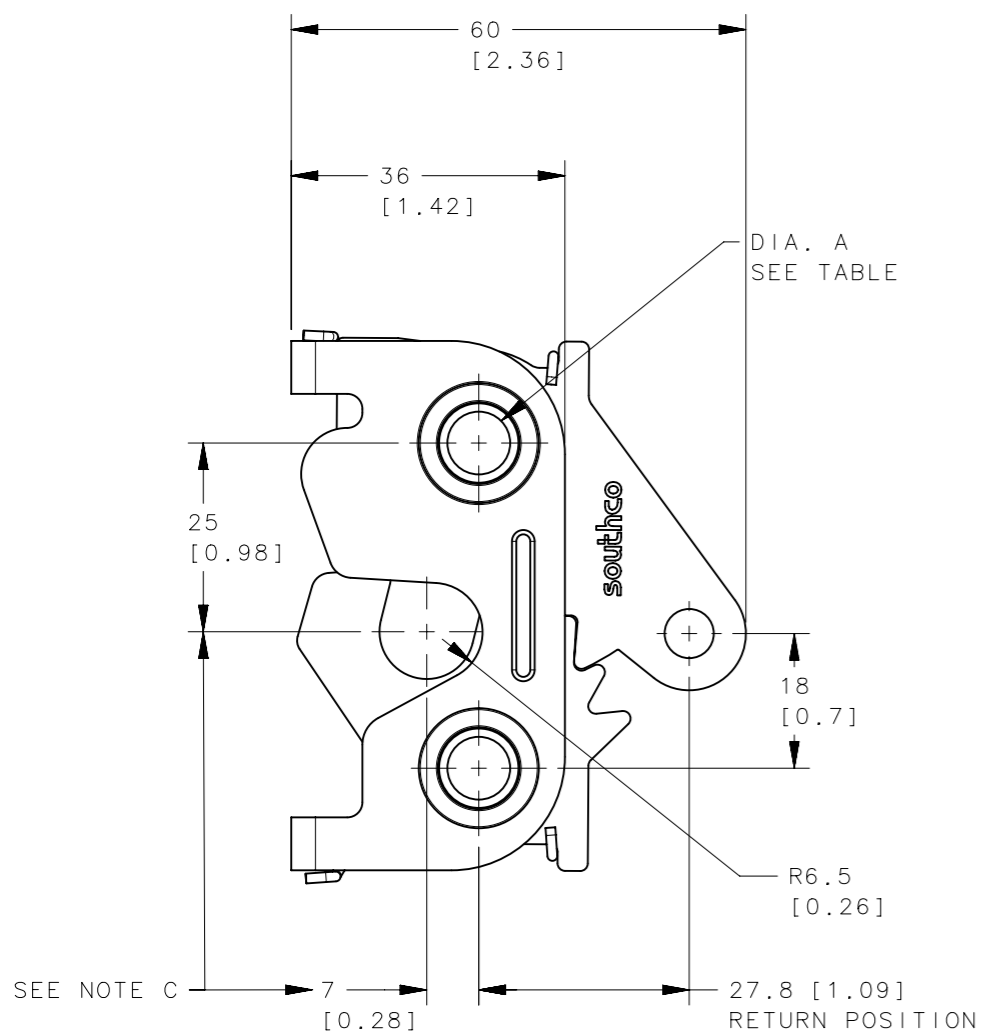

NOTES:

A. MATERIAL AND FINISH:

- HOUSING AND PIN: STEEL, ZINC PLATED, BRIGHT CHROMATE.
- PAWL AND TRIGGER: HARDENED STEEL, ZINC PLATED, BRIGHT CHROMATE.
- SPRING: STAINLESS STEEL, PASSIVATED.

B. REFER TO TRADE DRAWING J-AC-C FOR CABLE SELECTION.

C. THESE DIMENSIONS REQUIRED FOR MOUNTING STRIKER BOLT.

| SOUTHCO PART No. | ITEM | DIMENSION A | MATERIAL | FINISH |
|------------------|---------------------------------|----------------------------|------------|------------|
| R4-20-40-501-10 | $\varnothing 8.3$ THRU ASSEMBLY | $\varnothing 8.3 \pm 0.12$ | SEE NOTE A | SEE NOTE A |
| R4-20-41-501-10 | 5/16-18 THREAD ASSEMBLY | 5/16 - 18 | SEE NOTE A | SEE NOTE A |
| R4-20-42-501-10 | M8 THREAD ASSEMBLY | M8 x 1.25 | SEE NOTE A | SEE NOTE A |

| | | | | |
|--|--|------------------------------------|-------------------|---------------------------|
| THIRD ANGLE PROJECTION | | CONNECT • CREATE • INNOVATE | | |
| MILLIMETERS [IN] | | | | |
| TOLERANCES UNLESS OTHERWISE NOTED | | DESCRIPTION PUSH TO CLOSE LATCH | | |
| ALL DIMENSIONS WITHOUT TOLERANCES ARE FOR REFERENCE ONLY. | | SIZE A3 | SYSTEM NX | DWG NO. J-R4-20-40-501 |
| PER ASME Y14.5M-1994 | | DRAWN BY ACH/DS | DATE 21NOV2008 | SCALE 1:1 |
| <small>PROPRIETARY ITEM EXCEPT FOR USES EXPRESSLY GRANTED IN WRITING, INFORMATION DISCLOSED HEREON IS CONFIDENTIAL AND ALL RIGHTS, PATENT AND OTHERWISE, ARE RESERVED BY SOUTHCO, INC.</small> | | SHEET 1 OF 3 | | |

| REVISION HISTORY | | | |
|------------------|-----------|---------|-----------------|
| REV | DATE | BY | DESCRIPTION |
| K | 30JUN2016 | AVC/NJF | PRN: P2016-1614 |

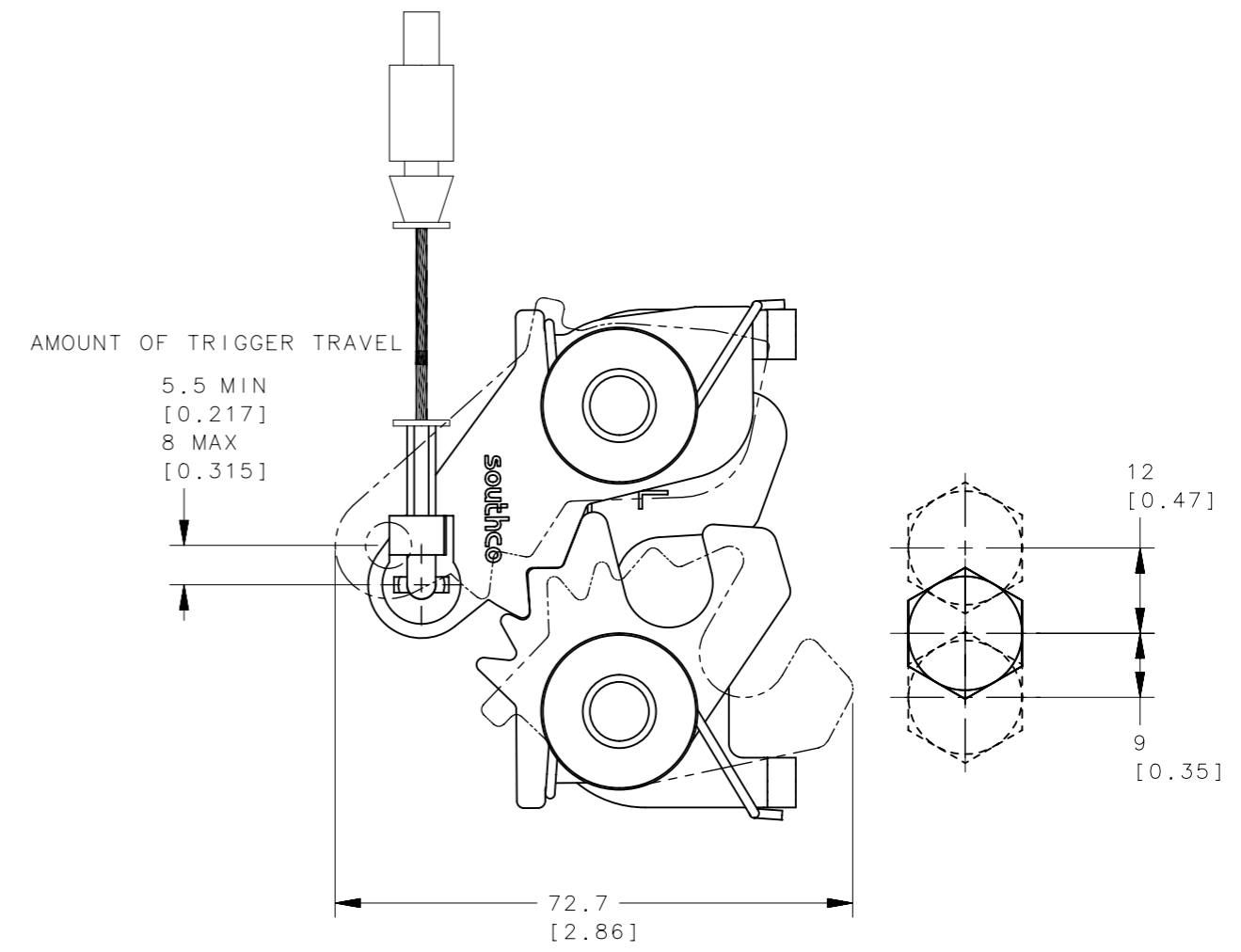
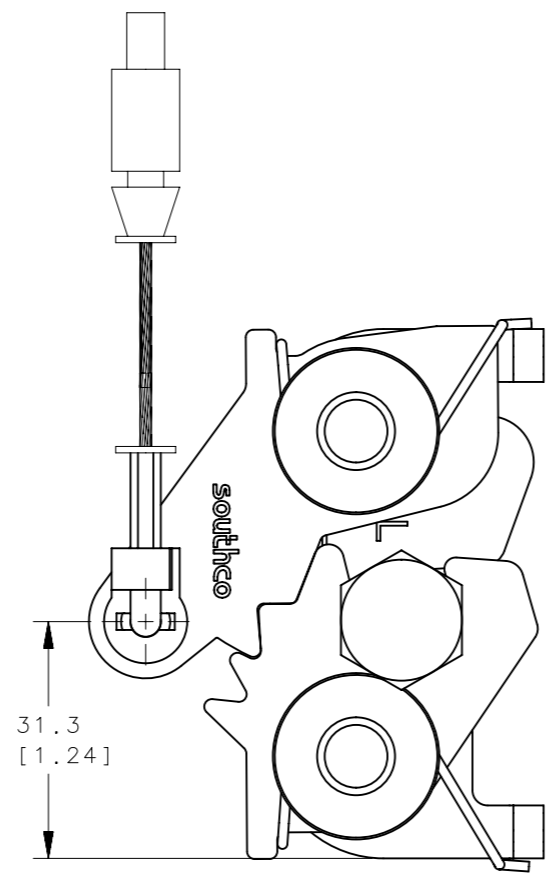
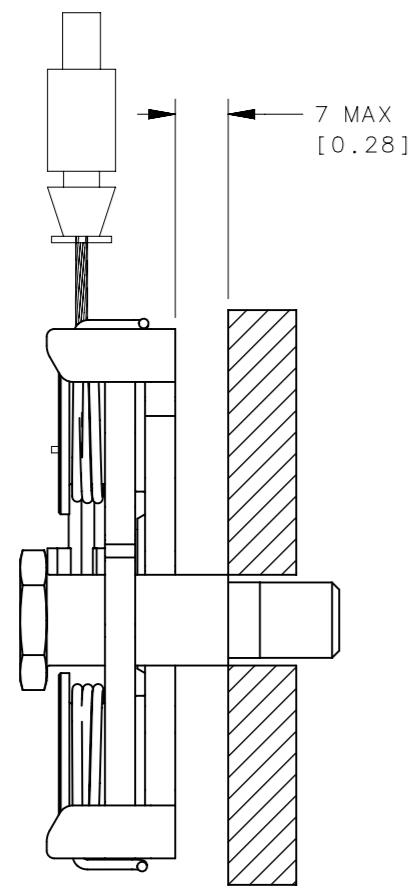

MISALIGNMENT VIEW
(SEE NOTE D)

NOTES:

D. THE TOLERANCE BETWEEN THE LATCH AND STRIKER BOLT ASSUMES A NON-RIGID DOOR INSTALLATION THAT WILL ALLOW THE DOOR TO MOVE INTO THE NOMINAL POSITION DURING LATCHING. RIGID DOORS MUST HAVE THE STRIKER INSTALLED PER THE PANEL PREPARATION RECOMMENDATION.

| SOUTHCO PART No. | ITEM | DIMENSION A | MATERIAL | FINISH |
|------------------|-------------------------|-------------|------------|------------|
| R4-20-40-501-10 | Ø 8.3 THRU ASSEMBLY | Ø 8.3 ±0.12 | SEE NOTE A | SEE NOTE A |
| R4-20-41-501-10 | 5/16-18 THREAD ASSEMBLY | 5/16 - 18 | SEE NOTE A | SEE NOTE A |
| R4-20-42-501-10 | M8 THREAD ASSEMBLY | M8 x 1.25 | SEE NOTE A | SEE NOTE A |

| | | | | |
|--|--|------------------------------------|-------------------|---------------------------|
| THIRD ANGLE PROJECTION | | CONNECT • CREATE • INNOVATE | | |
| MILLIMETERS [IN] | | | | |
| TOLERANCES UNLESS OTHERWISE NOTED | | DESCRIPTION PUSH TO CLOSE LATCH | | |
| ALL DIMENSIONS WITHOUT TOLERANCES ARE FOR REFERENCE ONLY. | | SIZE A3 | SYSTEM NX | DWG NO. J-R4-20-40-501 |
| PER ASME Y14.5M-1994 | | DRAWN BY ACH/DS | DATE 21NOV2008 | SCALE 1:1 |
| <small>PROPRIETARY ITEM EXCEPT FOR USES EXPRESSLY GRANTED IN WRITING, INFORMATION DISCLOSED HEREON IS CONFIDENTIAL AND ALL RIGHTS, PATENT AND OTHERWISE, ARE RESERVED BY SOUTHCO, INC.</small> | | SHEET 2 OF 3 | | |

| REVISION HISTORY | | | |
|------------------|-----------|---------|-----------------|
| REV | DATE | BY | DESCRIPTION |
| K | 30JUN2016 | AVC/NJF | PRN: P2016-1614 |

NOTE:
ASSEMBLY SHOWN WITH SOUTHCO CABLE FITTING "B" AND CABLE "13". SEE J-AC-C FOR DETAILS

STRIKER BOLT
PART NUMBER R4-91-2X1-10
(SOLD SEPARATELY,
SEE J-R4-91-200 FOR DETAILS)

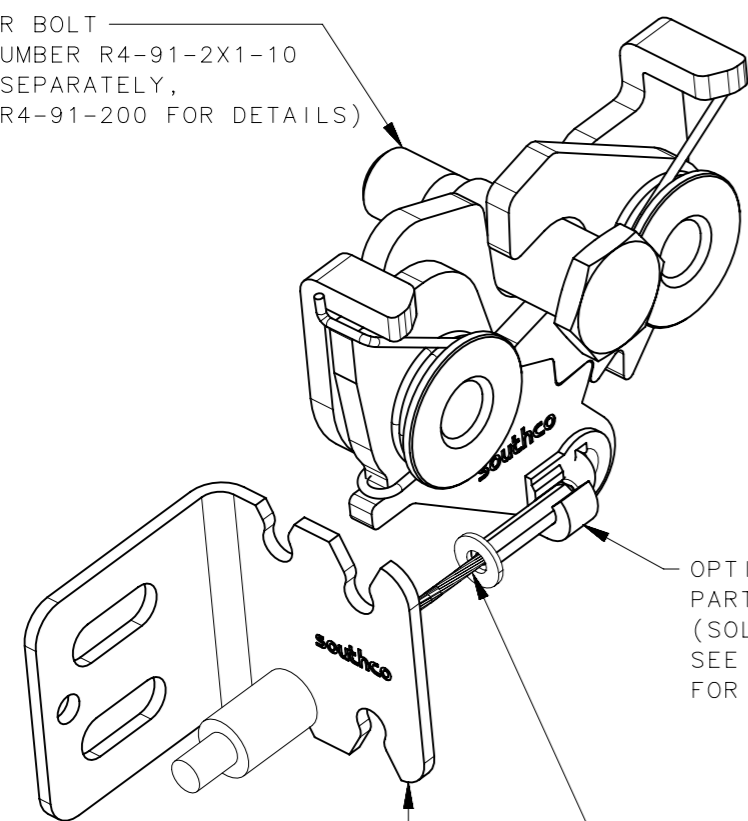

OPTIONAL CLIP
PART NUMBER R4-0-43922-1
(SOLD SEPARATELY,
SEE DRAWING J-R4-0-43922
FOR DETAILS)

OPTIONAL CABLE ASSEMBLY
MOUNTING BRACKET
PART NUMBER AC-900-02-10
(SOLD SEPARATELY)

INSTALL USING 3 SCREWS
(2 MOUNTING, 1 SET)
(SCREWS NOT SUPPLIED)
SEE J-AC-900-02-10 FOR
DETAILS

OPTIONAL CABLE ASSEMBLY
SEE DRAWING J-AC-C FOR DETAILS
(SOLD SEPARATELY)

(CABLE SHOWN WITH
CABLE FITTING "B" IN
A CABLE ASSEMBLY "13")

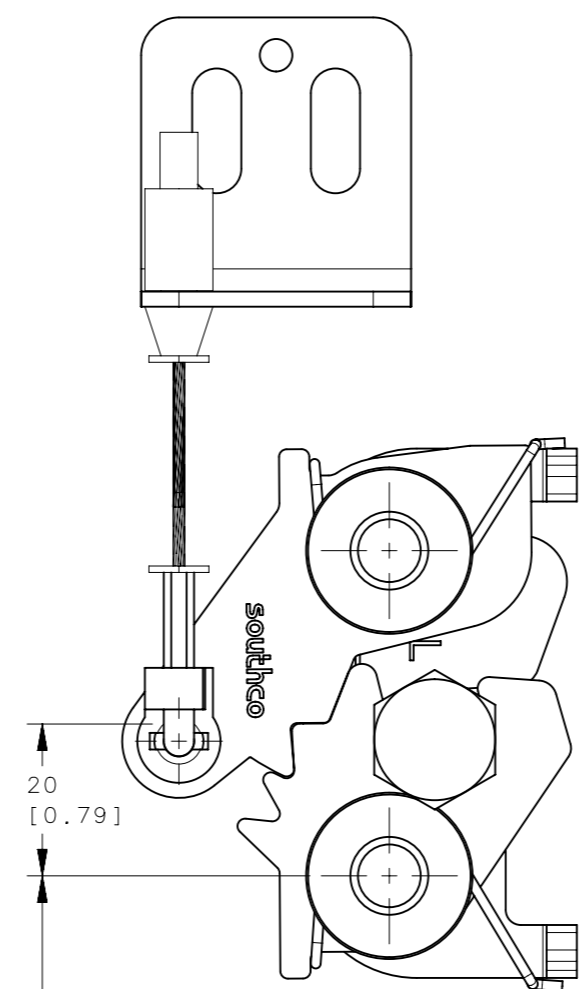

20
[0.79]

MOUNTING HOLE TO CABLE OR
ROD BEARING POINT. USE TO DETERMINE THE
OVERALL CABLE LENGTH, SEE J-AC-C FOR
ADDITIONAL DETAILS

ROD OPTION

Ø 4 ±0.1
[0.16 ±0.004]

R2.5 MAX
[0.1]

13.5 ±0.5
[0.53 ±0.02]

| | | | | |
|------------------|-------------------------|-------------|------------|------------|
| R4-20-40-501-10 | Ø 8.3 THRU ASSEMBLY | Ø 8.3 ±0.12 | SEE NOTE A | SEE NOTE A |
| R4-20-41-501-10 | 5/16-18 THREAD ASSEMBLY | 5/16 - 18 | SEE NOTE A | SEE NOTE A |
| R4-20-42-501-10 | M8 THREAD ASSEMBLY | M8 x 1.25 | SEE NOTE A | SEE NOTE A |
| SOUTHCO PART No. | ITEM | DIMENSION A | MATERIAL | FINISH |

THIRD ANGLE
PROJECTION

MILLIMETERS [IN]

SURFACE AREA
VOLUME

TOLERANCES UNLESS OTHERWISE NOTED
ALL DIMENSIONS WITHOUT
TOLERANCES ARE FOR
REFERENCE ONLY.

PROPRIETARY ITEM
EXCEPT FOR USES EXPRESSLY GRANTED
IN WRITING, INFORMATION DISCLOSED
HEREON IS CONFIDENTIAL AND ALL
RIGHTS, PATENT AND OTHERWISE,
ARE RESERVED BY SOUTHCO, INC.

PER ASME Y14.5M-1994

southco[®]
CONNECT • CREATE • INNOVATE

PUSH TO CLOSE LATCH

SIZE A3 SYSTEM NX DWG NO. J-R4-20-40-501

DRAWN BY ACH/DS DATE 21NOV2008 SCALE 1:1 SHEET 3 OF 3