

6

5

4

3

2

1

REVISION HISTORY			
REV	DATE	BY	DESCRIPTION
B	29JUL2021	KSH/HPD	PRN: P2021-1536

2X LATCH MOUNTING HOLE (SEE TABLE)

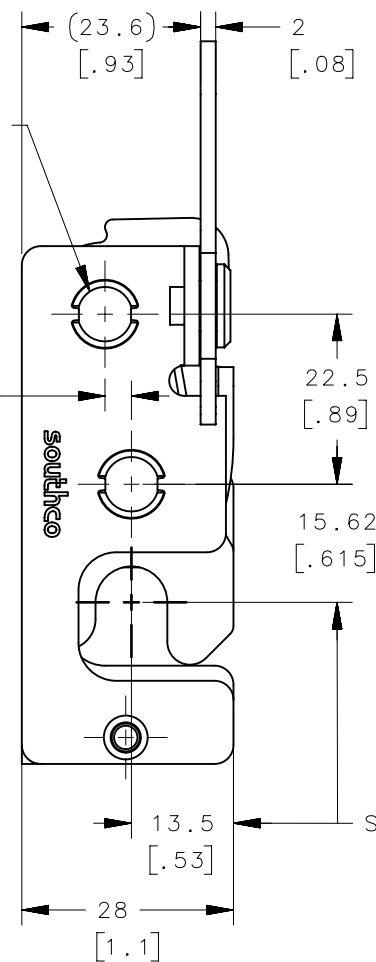

SEE NOTE B

PULL DIRECTION

PULL DIRECTION

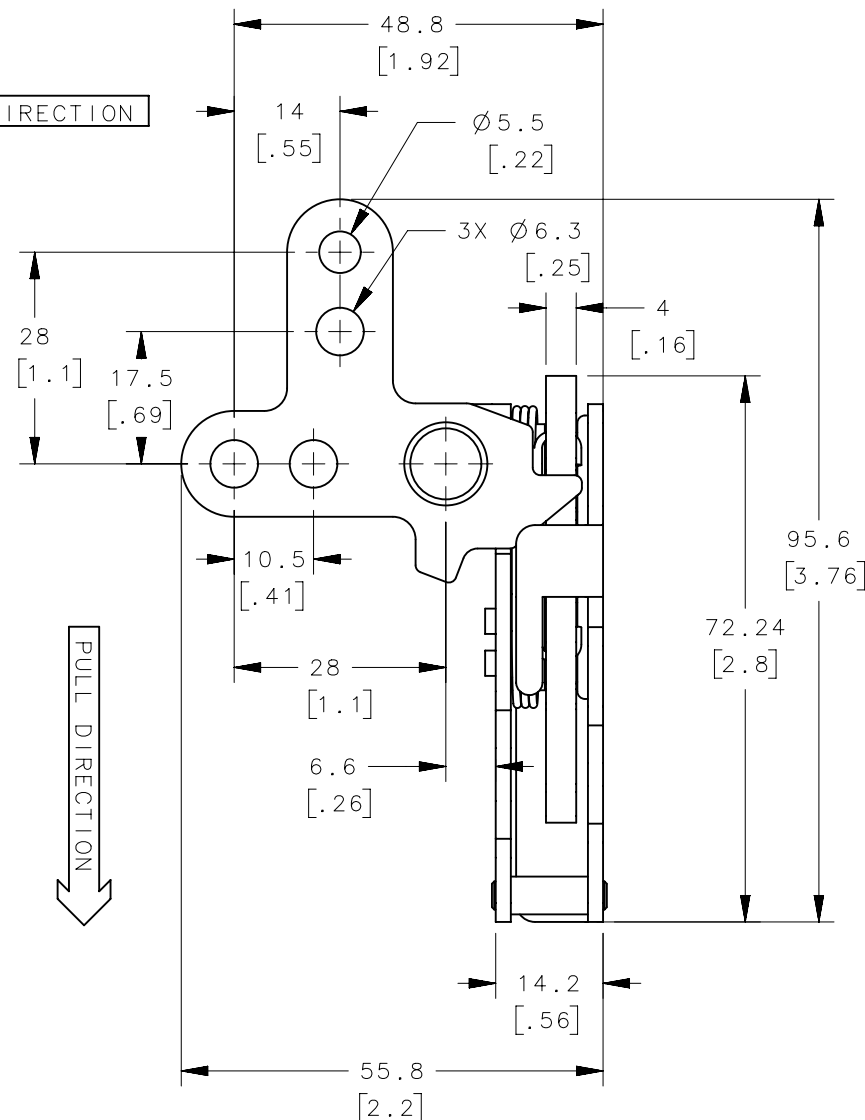

2X MINIMUM RECOMMENDED PANEL HOLES (SEE TABLE)

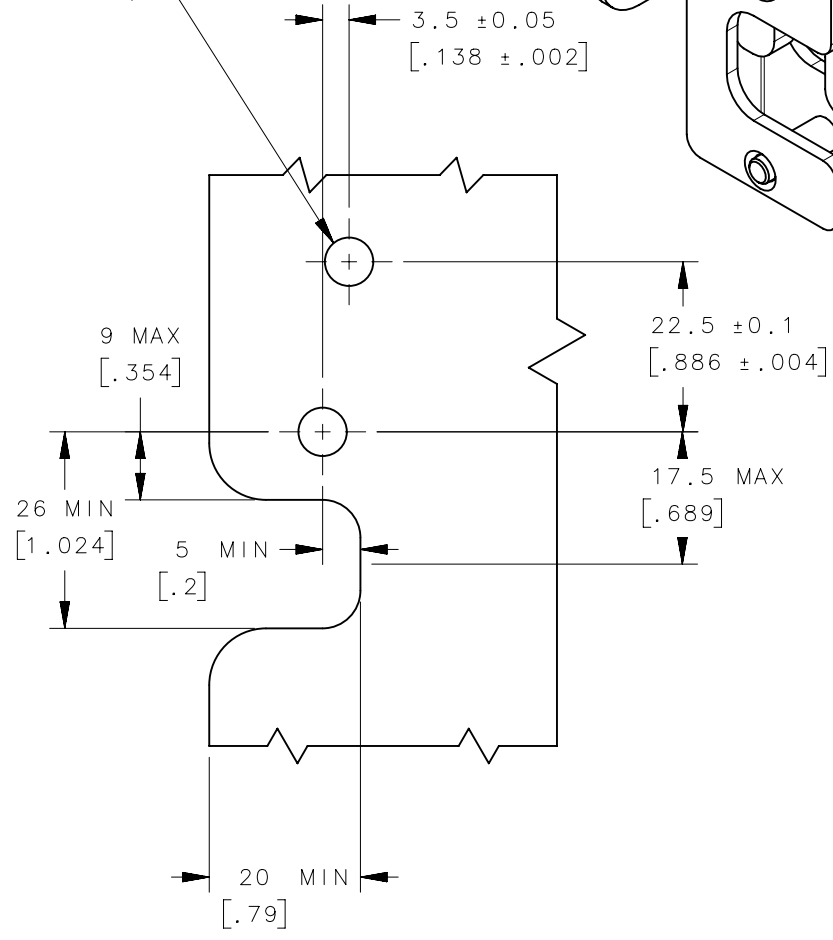
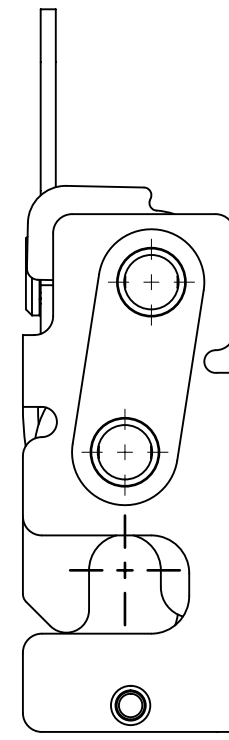

PANEL PREPARATION

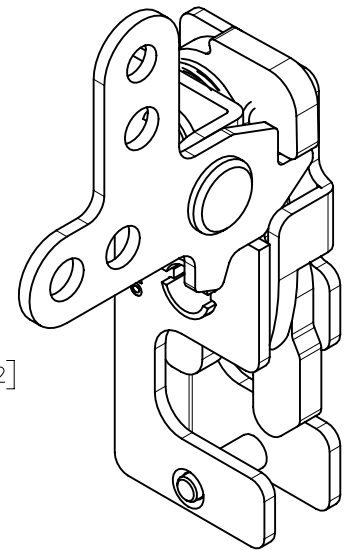

NOTES:

- A. MATERIAL AND FINISH:
- ALL PARTS STAINLESS STEEL,
- B. THESE DIMENSIONS REQUIRED FOR MOUNTING STRIKER BOLT.
- C. Ø6.3 (.25) LEVER HOLES USE OPTIONAL CABLE RETAINER R4-0-43922 SOLD SEPARATELY.

R4-10-40-301-20	Ø 7.2mm THRU	Ø 7.6 [.299]	SEE NOTE A	SEE NOTE A
R4-10-41-301-20	1/4-20 THREAD	Ø 6.8 [.268]		
R4-10-42-301-20	M6 THREAD	Ø 6.4 [.252]		
ASSEMBLY PART NUMBER	LATCH MOUNTING HOLE	MINIMUM RECOMMENDED PANEL HOLE	MATERIAL	FINISH

THIRD ANGLE PROJECTION

MILLIMETERS [IN]

TOLERANCES UNLESS OTHERWISE NOTED

ALL DIMENSIONS WITHOUT TOLERANCES ARE FOR REFERENCE ONLY.

PER ASME Y14.5M-1994



DESCRIPTION
R4 SS MINI TWO STAGE ROTARY LATCH
TWO POINT ACTUATION - LEFT HAND

SIZE B SYSTEM NX DWG NO. J-R4-10-40-301-20

DRAWN BY YSN/ACH DATE 26APR2012 SCALE 1:1 SHEET 1 OF 2

6

5

4

3

2

1

REVISION HISTORY			
REV	DATE	BY	DESCRIPTION
B	29JUL2021	KSH/HPD	PRN: P2021-1536

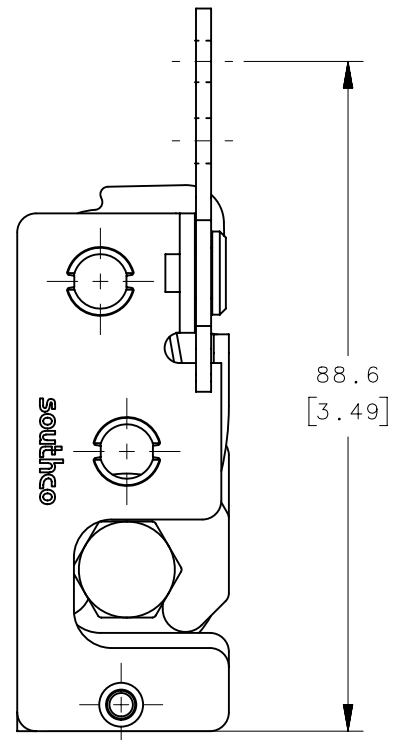

PULL DIRECTION

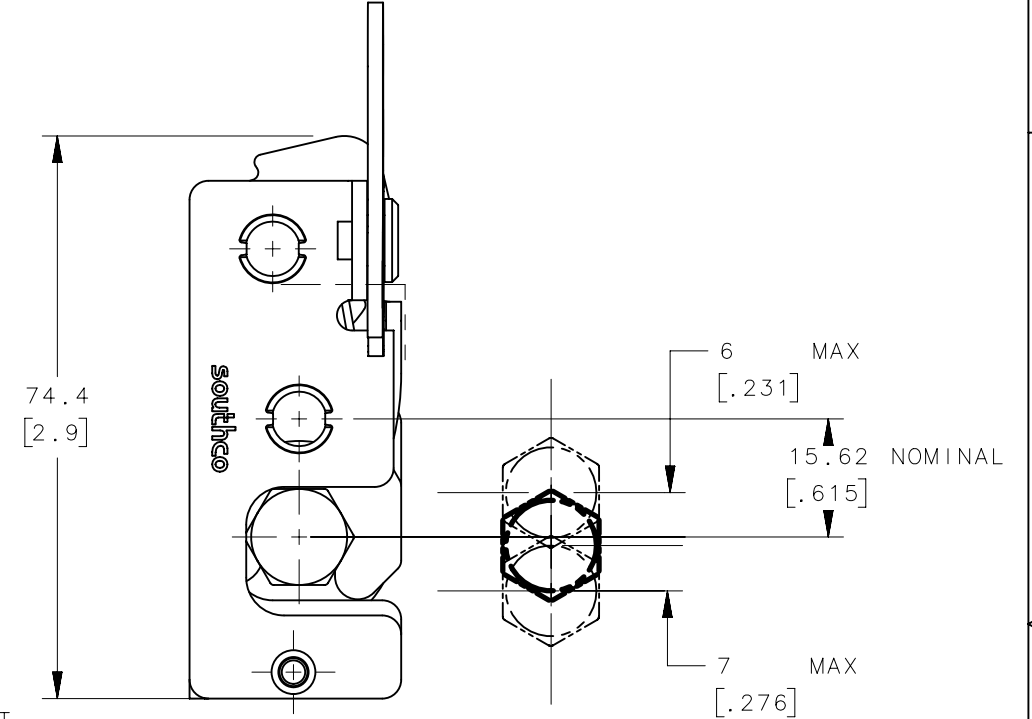
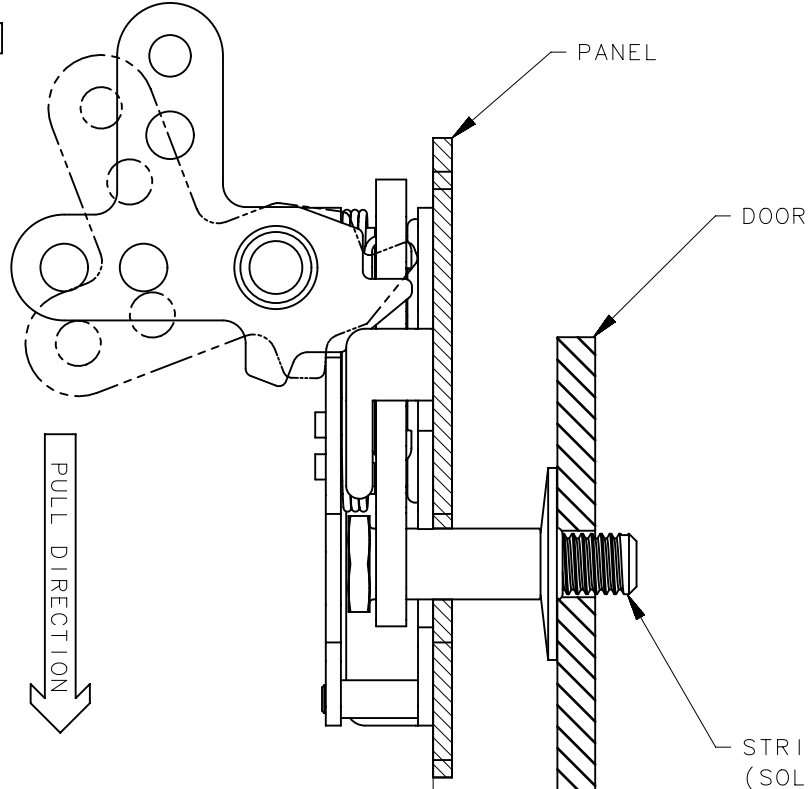

74.4
[2.9]

STRIKER BOLT
(SOLD SEPARATELY,
SEE R4-90-121-20
FOR DETAILS)

MISALIGNMENT VIEW
(SEE NOTE B)

NOTES:

- A. THE TOLERANCE BETWEEN THE LATCH AND STRIKER BOLT ASSUMES A NON-RIGID DOOR INSTALLATION THAT WILL ALLOW THE DOOR TO MOVE INTO THE NOMINAL POSITION DURING LATCHING. RIGID DOORS MUST HAVE THE STRIKER INSTALLED PER THE PANEL PREPARATION RECOMMENDATION.
- B. THE MISALIGNMENT VIEW ASSUMES THE LATCH IS CONNECTED TO A PERFECTLY RIGID DOOR AND HINGE; THEREFORE, THERE IS NO DOOR AND/OR HINGE SLACK ASSOCIATED WITH THESE DIMENSIONS. THE MISALIGNMENT VIEW DOES NOT TAKE FLEXING OF THE STRIKER BOLT INTO ACCOUNT.

THIRD ANGLE PROJECTION				 CONNECT • CREATE • INNOVATE	
MILLIMETERS [IN]					
SURFACE AREA		TOLERANCES UNLESS OTHERWISE NOTED		DESCRIPTION	
VOLUME		ALL DIMENSIONS WITHOUT TOLERANCES ARE FOR REFERENCE ONLY.		R4 SS MINI TWO STAGE ROTARY LATCH TWO POINT ACTUATION - LEFT HAND	
PROPRIETARY ITEM		SIZE	SYSTEM	DWG NO.	
EXCEPT FOR USES EXPRESSLY GRANTED IN WRITING, INFORMATION DISCLOSED HEREON IS CONFIDENTIAL AND ALL RIGHTS, PATENT AND OTHERWISE, ARE RESERVED BY SOUTHCO, INC.		B	NX	J-R4-10-40-301-20	
PER ASME Y14.5M-1994		DRAWN BY	DATE	SCALE	SHEET
		YSN/ACH	26APR2012	1:1	2 OF 2