

HAND ACTUATION

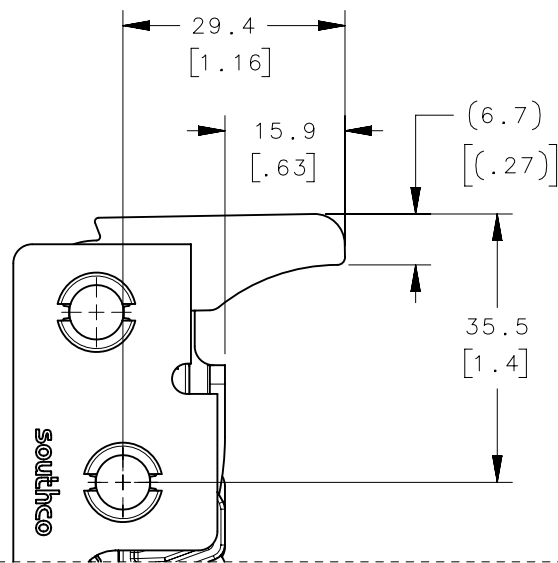

BOTTOM ACTUATION

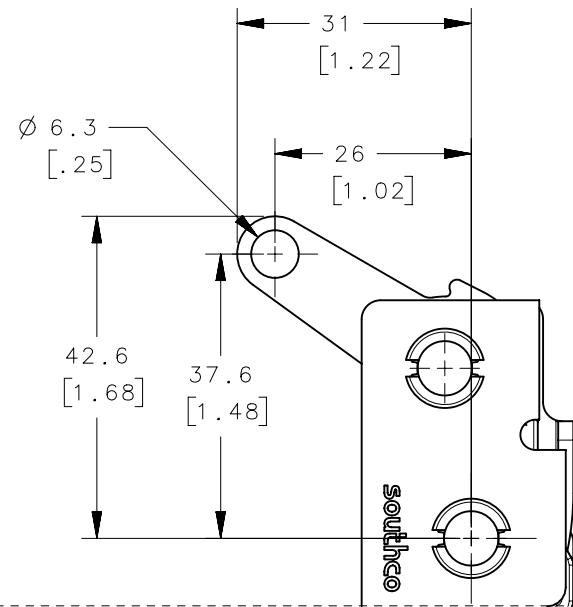

TOP ACTUATION

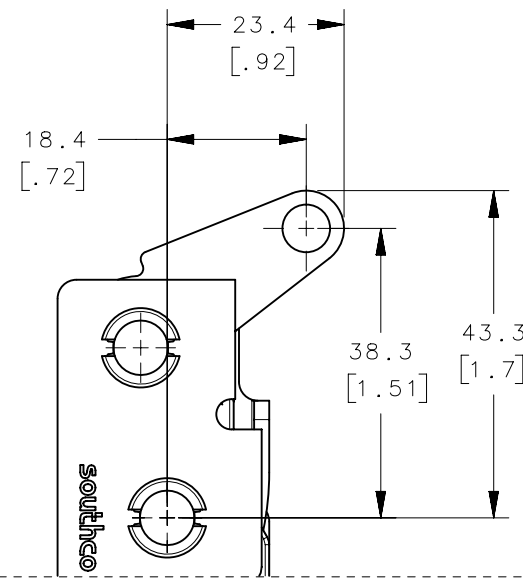

PANEL PREPARATION

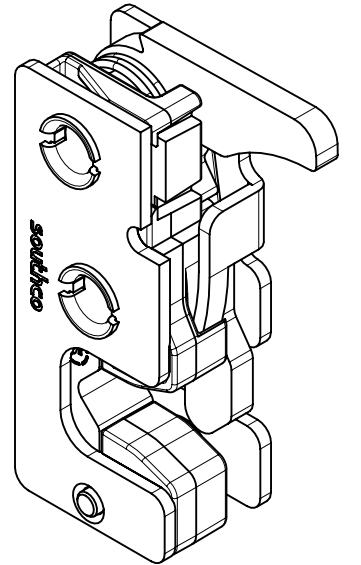
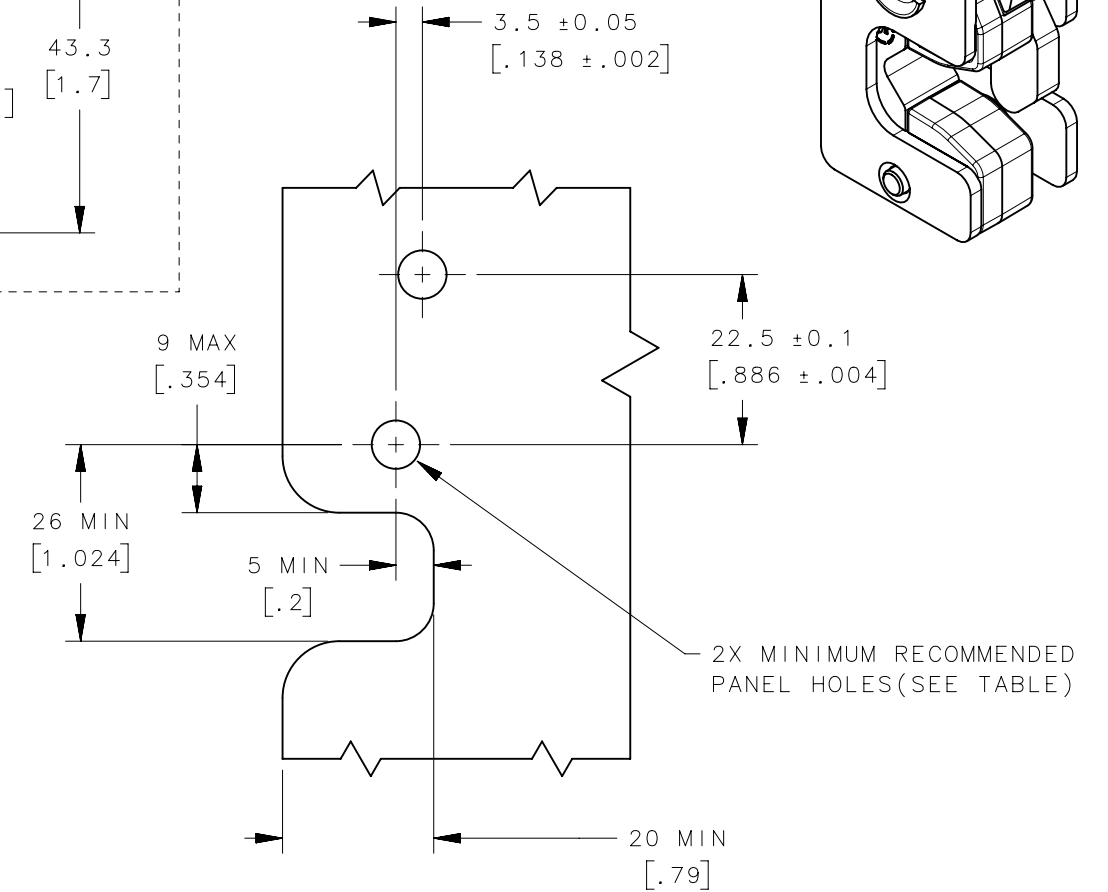

BOTTOM ACTUATION SHOWN

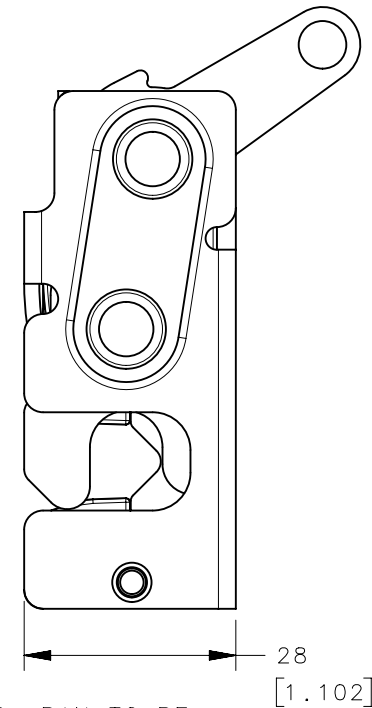
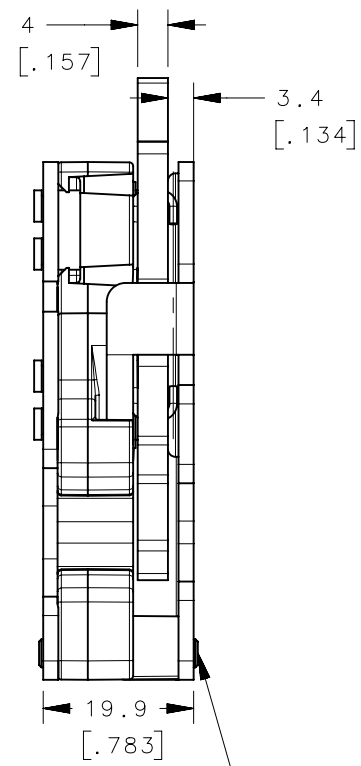
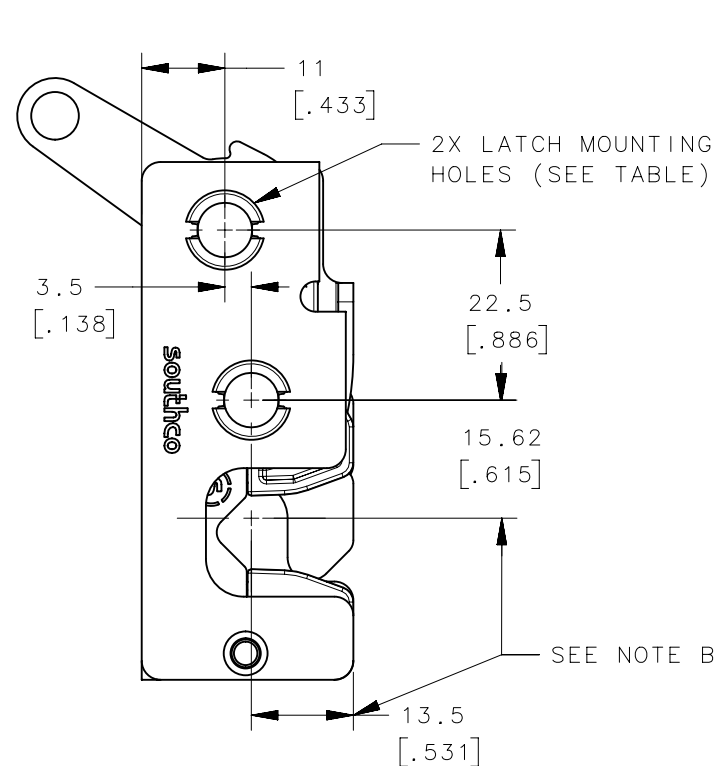

NOTES:

- A. MATERIAL:
 - HOUSING: STEEL
 - PAWL AND TRIGGER: HARDENED STEEL
 - SPRING: STAINLESS STEEL, PASSIVATED
- B. THESE DIMENSIONS REQUIRED FOR MOUNTING STRIKER BOLT.

ASSEMBLY PART No. R4-10-□-□05-□

STAGE & ACTUATION

- 2 - SINGLE STAGE, LEFT HAND
- 4 - TWO-STAGE, LEFT HAND

MOUNTING STYLE

- 0 - Ø7.2 (.283) THRU
- 1 - 1/4-20 THREAD
- 2 - M6x1 THREAD

LEVER TYPE

- 4 - HAND ACTUATION
- 5 - BOTTOM ACTUATION
- 6 - TOP ACTUATION

FINISH

- 10 - ZINC PLATE, BRIGHT CHROMATE
- 77 - ZINC NICKEL, BRIGHT CHROMATE

THIRD ANGLE PROJECTION

MILLIMETERS [IN]

TOLERANCES UNLESS OTHERWISE NOTED

ALL DIMENSIONS WITHOUT TOLERANCES ARE FOR REFERENCE ONLY.

PER ASME Y14.5M-1994

southco
CONNECT • CREATE • INNOVATE

DESCRIPTION R4 MINI ROTARY LATCH LEFT HAND - BSR INSERT

SIZE B SYSTEM NX DWG NO. J-R4-10-5BL

DRAWN BY CMG/DGJ DATE 25JUN2014 SCALE 1:1 SHEET 1 OF 3

PROPRIETARY ITEM EXCEPT FOR USES EXPRESSLY GRANTED IN WRITING, INFORMATION DISCLOSED HEREON IS CONFIDENTIAL AND ALL RIGHTS, PATENT AND OTHERWISE, ARE RESERVED BY SOUTHCO, INC.

REVISION HISTORY			
REV	DATE	BY	DESCRIPTION
C	02MAR2018	DKM/DMS	PRN: P2018-0542

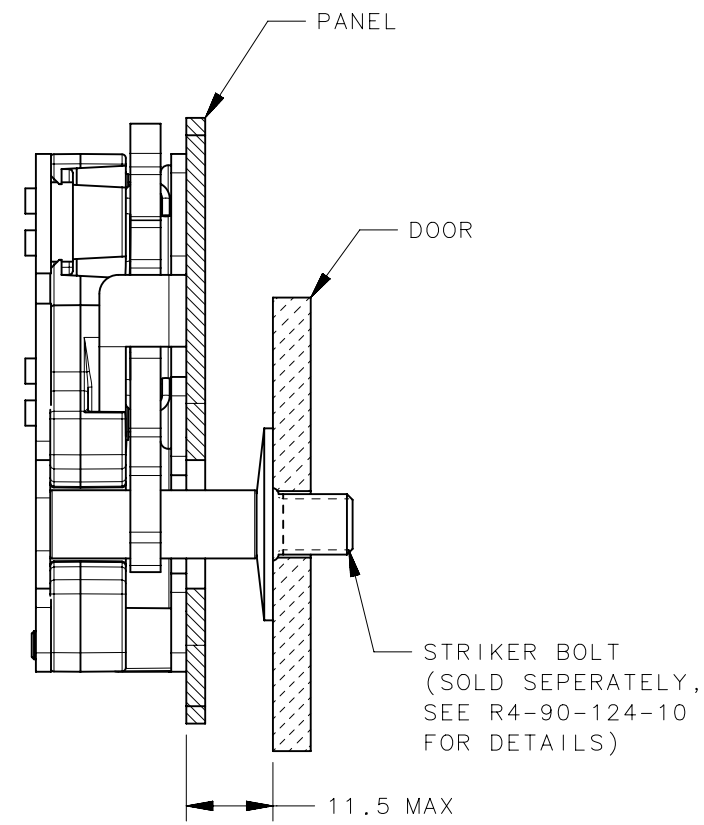

PRIMARY STAGE

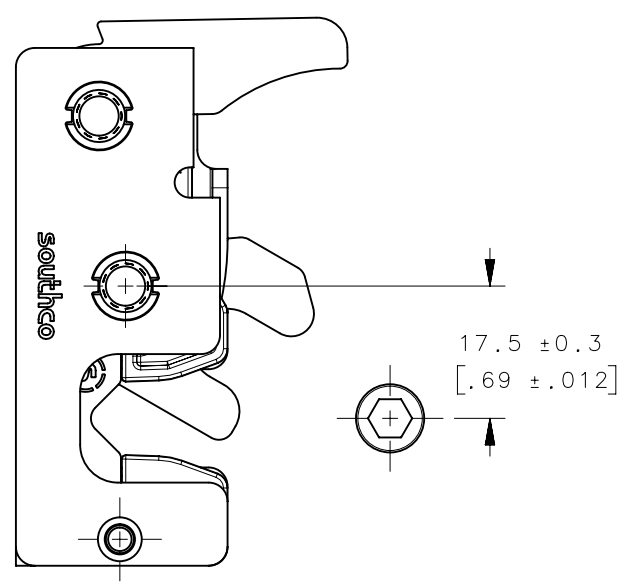

MISALIGNMENT VIEW
(SEE NOTE B)

SECONDARY STAGE

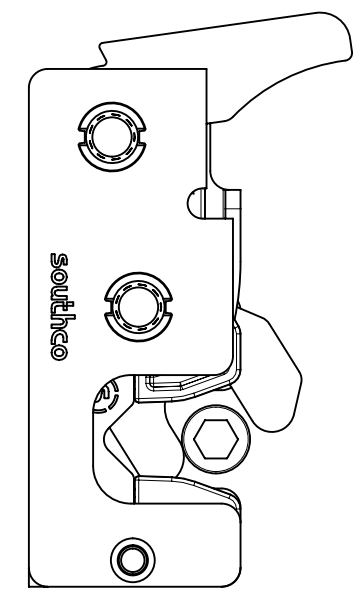

LATCHED STAGE

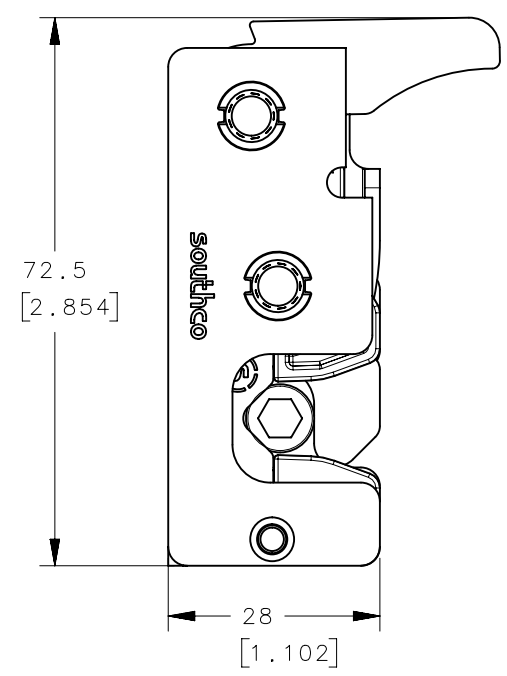

NOTES:

- A. THE TOLERANCE BETWEEN THE LATCH AND STRIKER BOLT ASSUMES A NON-RIGID DOOR INSTALLATION THAT WILL ALLOW THE DOOR TO MOVE INTO THE NOMINAL POSITION DURING LATCHING. RIGID DOORS MUST HAVE THE STRIKER INSTALLED PER THE PANEL PREPARATION RECOMMENDATION.
- B. THE MISALIGNMENT VIEW ASSUMES THE LATCH IS CONNECTED TO A PERFECTLY RIGID DOOR AND HINGE; THEREFORE, THERE IS NO DOOR AND/OR HINGE SLACK ASSOCIATED WITH THESE DIMENSIONS. THE MISALIGNMENT VIEW DOES NOT TAKE FLEXING OF THE STRIKER BOLT INTO ACCOUNT.

R4-10-X0-X05-XX	Ø 7.2 THRU	Ø 7.2 [.299]
R4-10-X1-X05-XX	1/2-20 THREAD	Ø 6.8 [.268]
R4-10-X2-X05-XX	M6X1 THREAD	Ø 6.4 [.252]
PART NUMBER	MOUNTING STYLE	MINIMUM PANEL HOLE

THIRD ANGLE PROJECTION			southco [®] CONNECT · CREATE · INNOVATE	
MILLIMETERS [IN]				
TOLERANCES UNLESS OTHERWISE NOTED	DESCRIPTION R4 MINI ROTARY LATCH LEFT HAND - BSR INSERT			
ALL DIMENSIONS WITHOUT TOLERANCES ARE FOR REFERENCE ONLY.	SIZE B	SYSTEM NX	DWG NO. J-R4-10-5BL	
PER ASME Y14.5M-1994	DRAWN BY CMG/DGJ	DATE 25JUN2014	SCALE 1:1	SHEET 2 OF 3

PROPRIETARY ITEM
EXCEPT FOR USES EXPRESSLY GRANTED IN WRITING, INFORMATION DISCLOSED HEREON IS CONFIDENTIAL AND ALL RIGHTS, PATENT AND OTHERWISE, ARE RESERVED BY SOUTHCO, INC.

REVISION HISTORY			
REV	DATE	BY	DESCRIPTION
C	02MAR2018	DKM/DMS	PRN: P2018-0542

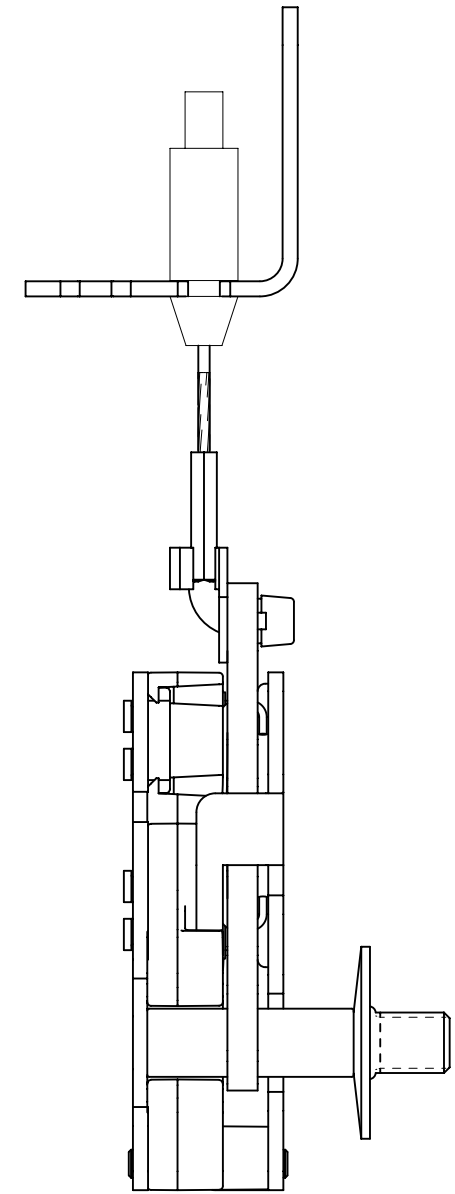
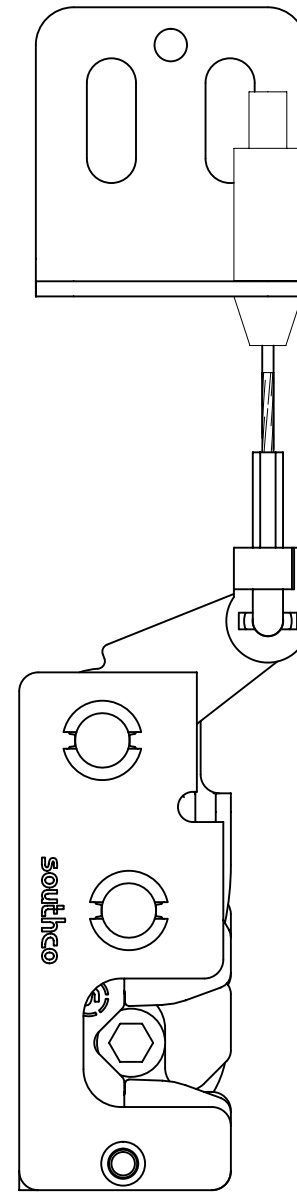
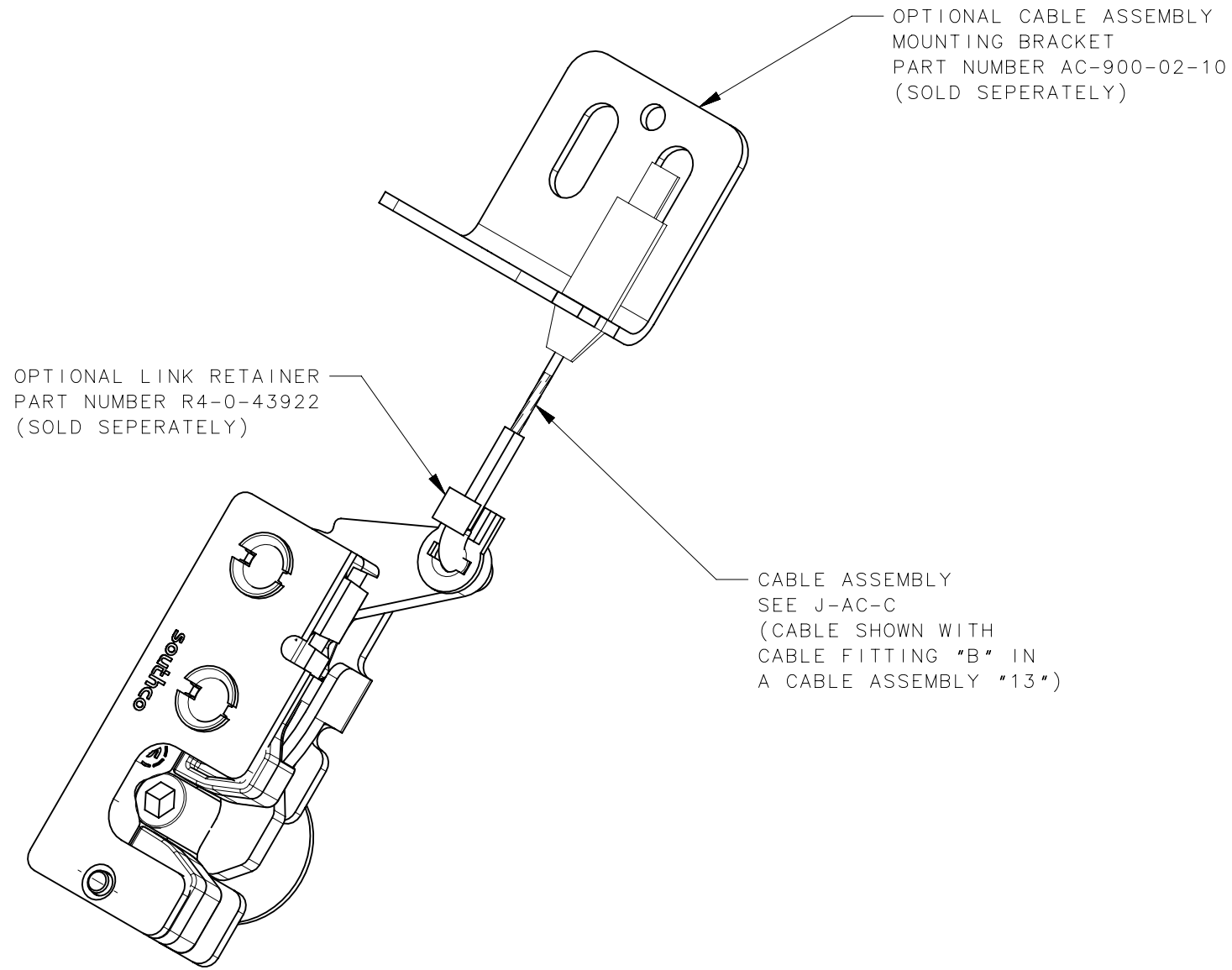

TOP ACTUATION SHOWN

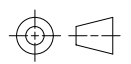
THIRD ANGLE PROJECTION 		southco [®] CONNECT • CREATE • INNOVATE	
MILLIMETERS [IN]			
TOLERANCES UNLESS OTHERWISE NOTED		DESCRIPTION R4 MINI ROTARY LATCH LEFT HAND - BSR INSERT	
ALL DIMENSIONS WITHOUT TOLERANCES ARE FOR REFERENCE ONLY.		SIZE B	SYSTEM NX
PER ASME Y14.5M-1994		DWG NO. J-R4-10-5BL	DATE 25JUN2014
PROPRIETARY ITEM EXCEPT FOR USES EXPRESSLY GRANTED IN WRITING, INFORMATION DISCLOSED HEREON IS CONFIDENTIAL AND ALL RIGHTS, PATENT AND OTHERWISE, ARE RESERVED BY SOUTHCO, INC.		DRAWN BY CMG/DGJ	SCALE 1:1
		SHEET 3 OF 3	