

REVISION HISTORY			
REV	DATE	BY	DESCRIPTION
G	09AUG2017	ACH/DGJ	PRN: P2017-1978

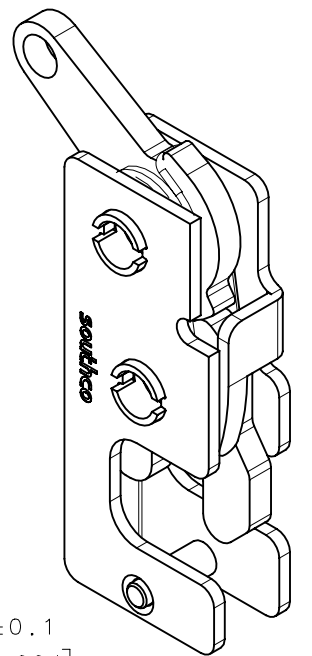
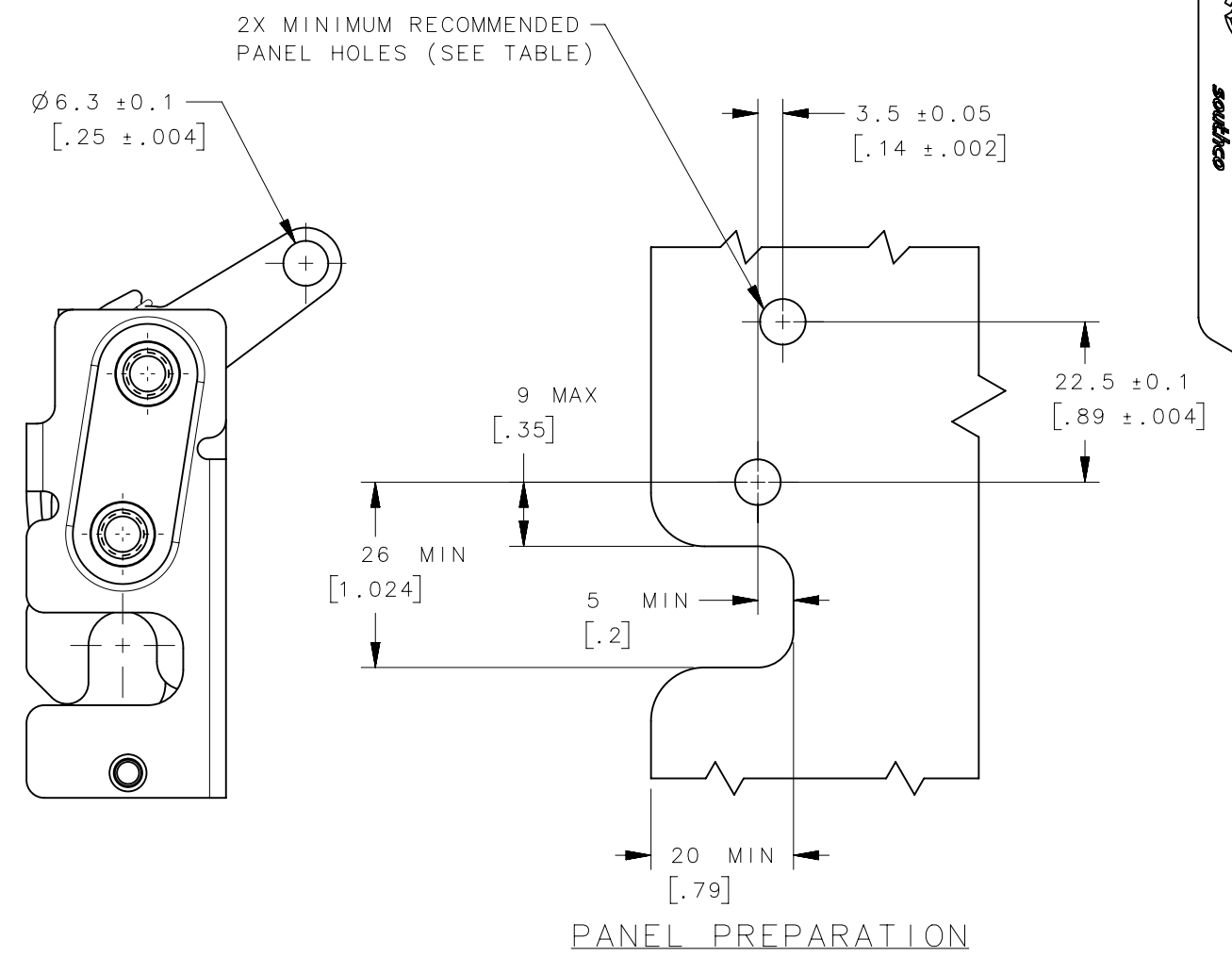
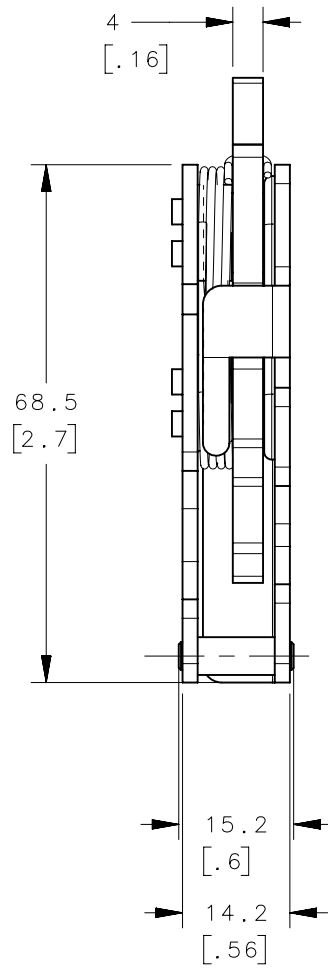
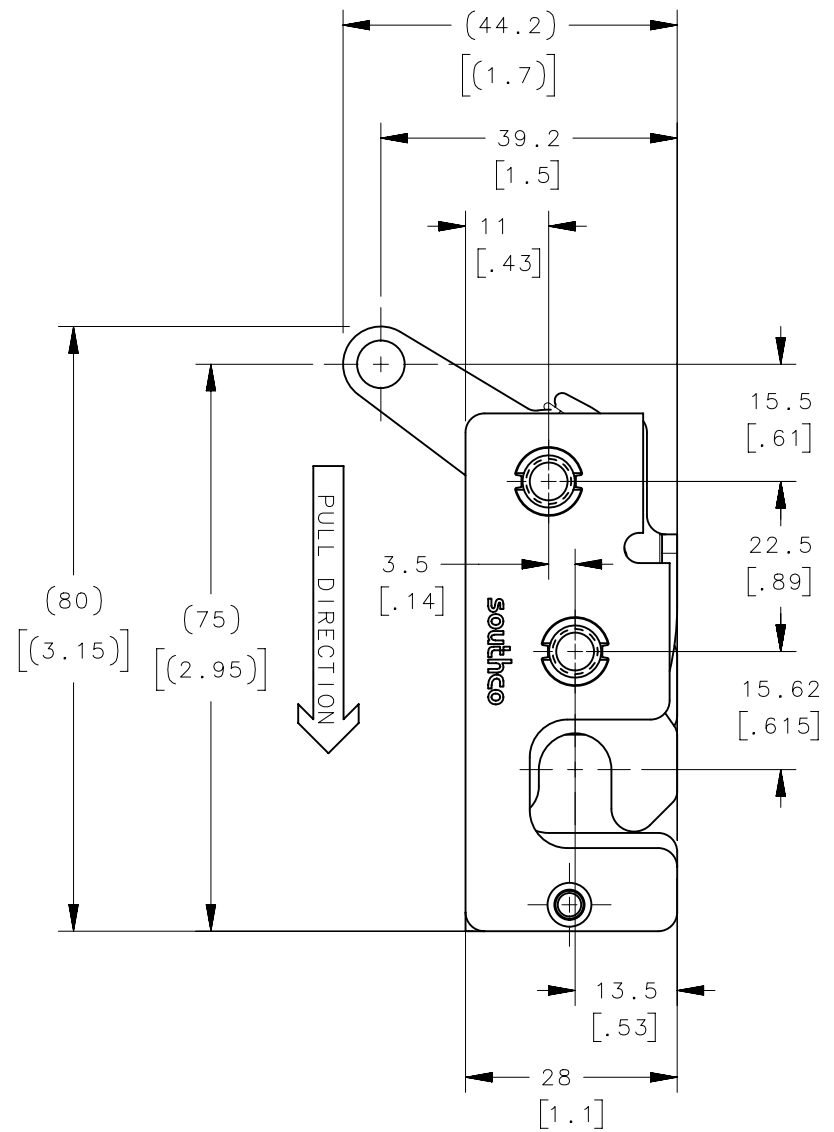

A. MATERIAL AND FINISH:

- HOUSING, LEVER AND INTERNAL COMPONENTS:
MATERIAL - STEEL
-10 ZINC PLATED, BRIGHT CHROMATE
-77 ZINC NICKEL, BRIGHT CHROMATE
- PAWL AND TRIGGER:
MATERIAL - HARDENED STEEL
-10 ZINC PLATED, BRIGHT CHROMATE
-77 ZINC NICKEL, BRIGHT CHROMATE
- SPRING: STAINLESS STEEL, PASSIVATED

B. THESE DIMENSIONS REQUIRED FOR MOUNTING STRIKER BOLT.

ASSEMBLY PART NUMBER	MOUNTING STYLE	MINIMUM PANEL HOLE
R4-10-20-101-10	Ø 7.2 THRU	Ø 7.2 [.299]
R4-10-21-101-10	1/2-20 THREAD	Ø 6.8 [.268]
R4-10-22-101-10	M6X1 THREAD	Ø 6.4 [.252]
R4-10-20-101-77	Ø 7.2 THRU	Ø 7.2 [.299]
R4-10-21-101-77	1/2-20 THREAD	Ø 6.8 [.268]
R4-10-22-101-77	M6X1 THREAD	Ø 6.4 [.252]

ASSEMBLY PART NUMBER	LATCH MOUNTING HOLE	MATERIAL	FINISH	GENERAL NOTES
R4-10-20-501-77	Ø 7.2mm ± .2 THRU	SEE NOTE A	SEE NOTE A	
R4-10-21-501-77	1/4-20 THREAD			
R4-10-22-501-77	M6 THREAD			
R4-10-20-501-10	Ø 7.2mm ± .2 THRU			
R4-10-21-501-10	1/4-20 THREAD			
R4-10-22-501-10	M6 THREAD			

THIRD ANGLE PROJECTION				
MILLIMETERS [IN]				
TOLERANCES UNLESS OTHERWISE NOTED	DESCRIPTION			
ALL DIMENSIONS WITHOUT TOLERANCES ARE FOR REFERENCE ONLY.	R4 MINI ROTARY LATCH WITH TRIGGER HOLE - LEFT HAND			
PROPRIETARY ITEM EXCEPT FOR USES EXPRESSLY GRANTED IN WRITING, INFORMATION DISCLOSED HEREON IS CONFIDENTIAL AND ALL RIGHTS, PATENT AND OTHERWISE, ARE RESERVED BY SOUTHCO, INC.	SIZE	SYSTEM	DWG NO.	
PER ASME Y14.5M-1994	B	NX	J-R4-10-20-501	
	DRAWN BY	DATE	SCALE	SHEET
	ACH/JCK	11NOV2010	1:1	1 OF 3

6

5

4

3

2

1

REVISION HISTORY			
REV	DATE	BY	DESCRIPTION
G	09AUG2017	ACH/DGJ	PRN: P2017-1978

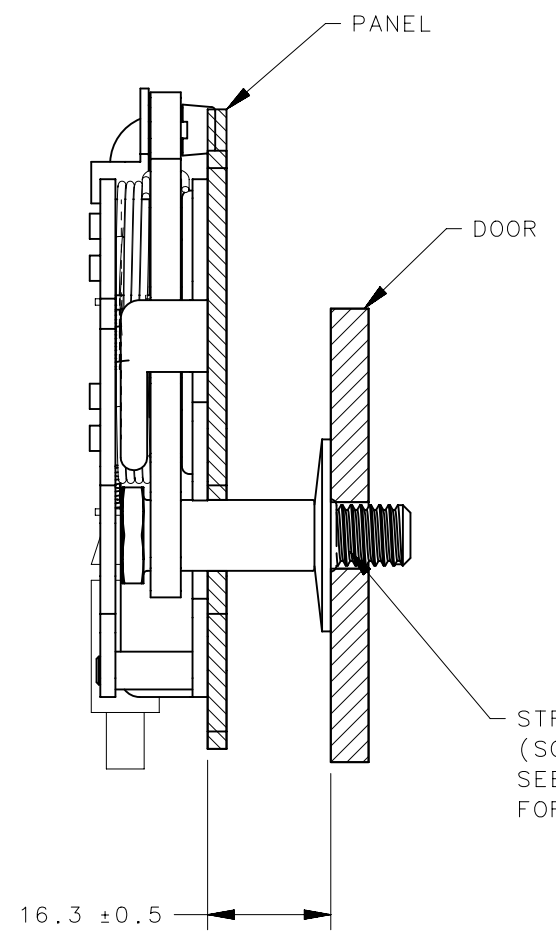
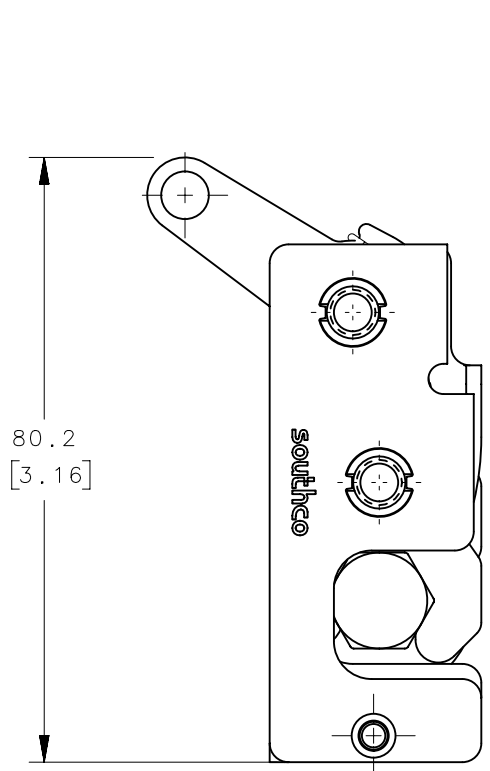

STRIKER BOLT
(SOLD SEPARATELY,
SEE J-R4-90-121
FOR DETAILS)

AMOUNT OF TRIGGER TRAVEL
6.4 MIN
[.25]
27 MAX
[1.06]

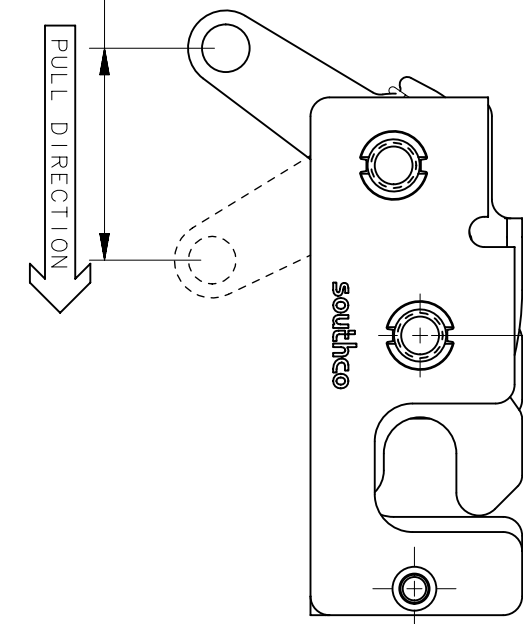

MISALIGNMENT VIEW
(SEE NOTE B)

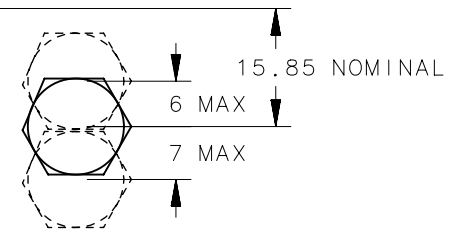

NOTES:

- A. THE TOLERANCE BETWEEN THE LATCH AND STRIKER BOLT ASSUMES A NON-RIGID DOOR INSTALLATION THAT WILL ALLOW THE DOOR TO MOVE INTO THE NOMINAL POSITION DURING LATCHING. RIGID DOORS MUST HAVE THE STRIKER INSTALLED PER THE PANEL PREPARATION RECOMMENDATION.
- B. THE MISALIGNMENT VIEW ASSUMES THE LATCH IS CONNECTED TO A PERFECTLY RIGID DOOR AND HINGE; THEREFORE, THERE IS NO DOOR AND/OR HINGE SLACK ASSOCIATED WITH THESE DIMENSIONS. THE MISALIGNMENT VIEW DOES NOT TAKE FLEXING OF THE STRIKER BOLT INTO ACCOUNT.

THIRD ANGLE PROJECTION		southco CONNECT • CREATE • INNOVATE	
MILLIMETERS [IN]			
TOLERANCES UNLESS OTHERWISE NOTED		DESCRIPTION R4 MINI ROTARY LATCH WITH TRIGGER HOLE - LEFT HAND	
ALL DIMENSIONS WITHOUT TOLERANCES ARE FOR REFERENCE ONLY.		SIZE B	SYSTEM NX
PROPRIETARY ITEM <small>EXCEPT FOR USES EXPRESSLY GRANTED IN WRITING, INFORMATION DISCLOSED HEREON IS CONFIDENTIAL AND ALL RIGHTS, PATENT AND OTHERWISE, ARE RESERVED BY SOUTHCO, INC.</small>		DWG NO. J-R4-10-20-501	DATE 11NOV2010
PER ASME Y14.5M-1994	DRAWN BY ACH/JCK	SCALE 1:1	SHEET 2 OF 3

6

5

4

3

2

1

6

5

4

3

2

1

REVISION HISTORY			
REV	DATE	BY	DESCRIPTION
G	09AUG2017	ACH/DGJ	PRN: P2017-1978

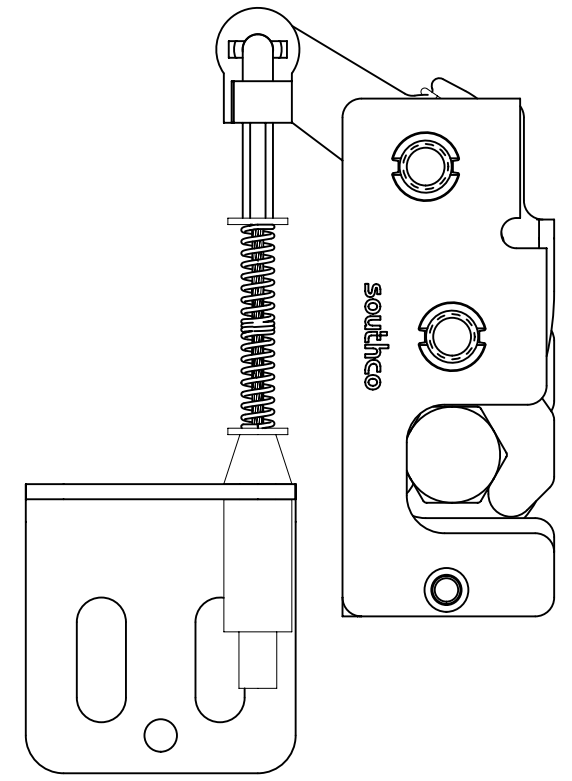
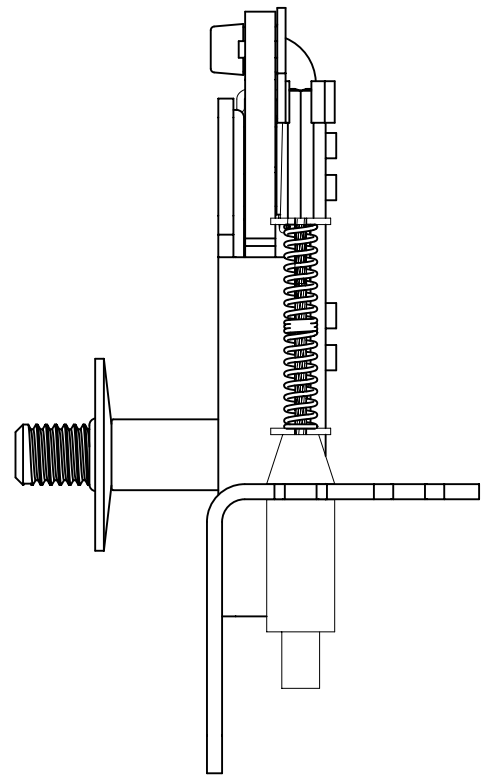
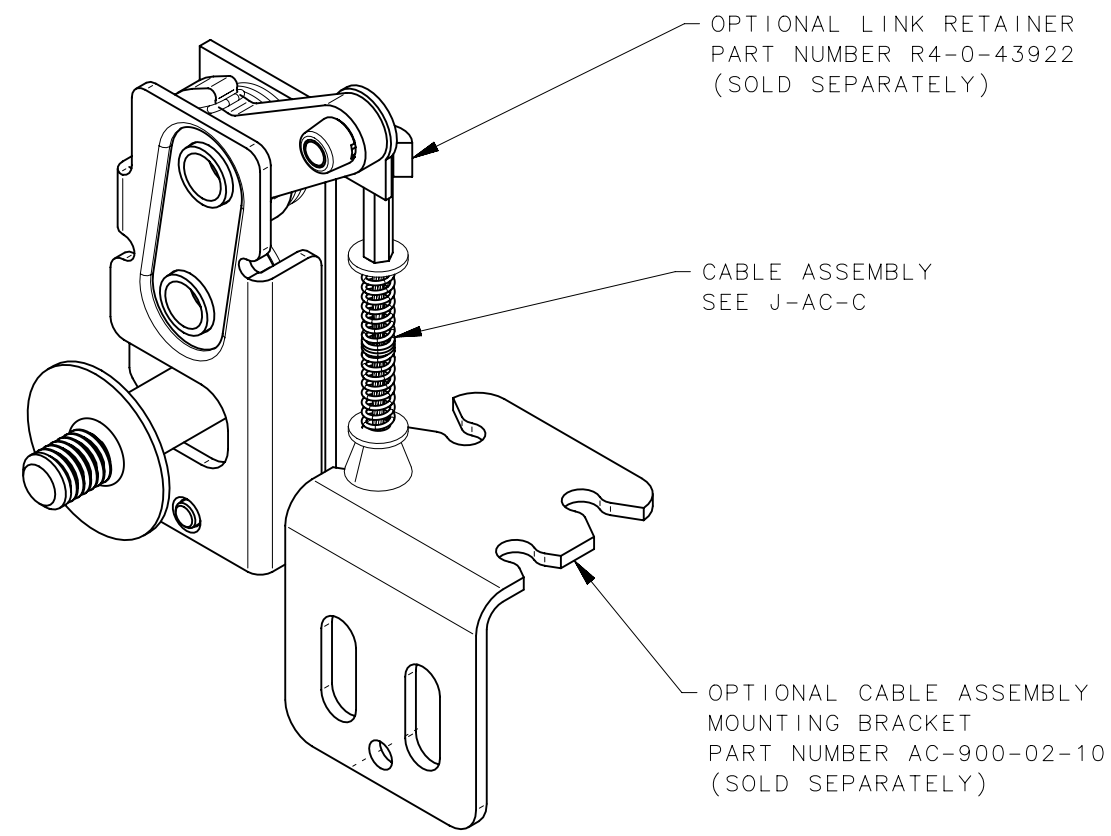

THIRD ANGLE PROJECTION		southco [®] CONNECT • CREATE • INNOVATE	
MILLIMETERS [IN]			
TOLERANCES UNLESS OTHERWISE NOTED		DESCRIPTION R4 MINI ROTARY LATCH WITH TRIGGER HOLE - LEFT HAND	
ALL DIMENSIONS WITHOUT TOLERANCES ARE FOR REFERENCE ONLY.		SIZE B	SYSTEM NX
PER ASME Y14.5M-1994		DWG NO. J-R4-10-20-501	SCALE 1:1
PROPRIETARY ITEM <small>EXCEPT FOR USES EXPRESSLY GRANTED IN WRITING, INFORMATION DISCLOSED HEREON IS CONFIDENTIAL AND ALL RIGHTS, PATENT AND OTHERWISE, ARE RESERVED BY SOUTHCO, INC.</small>		DRAWN BY ACH/JCK	DATE 11NOV2010
		SHEET 3 OF 3	

6

5

4

3

2

1