

6

5

4

3

2

1

REVISION HISTORY			
REV	DATE	BY	DESCRIPTION
C	11MAY2011	ACH/JCK	PRN: P2011-0543

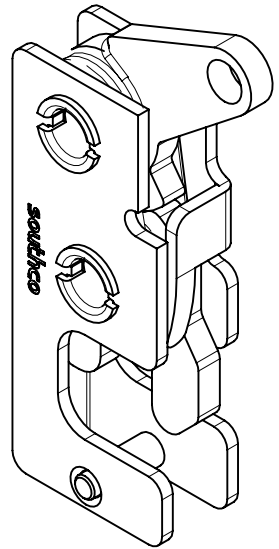
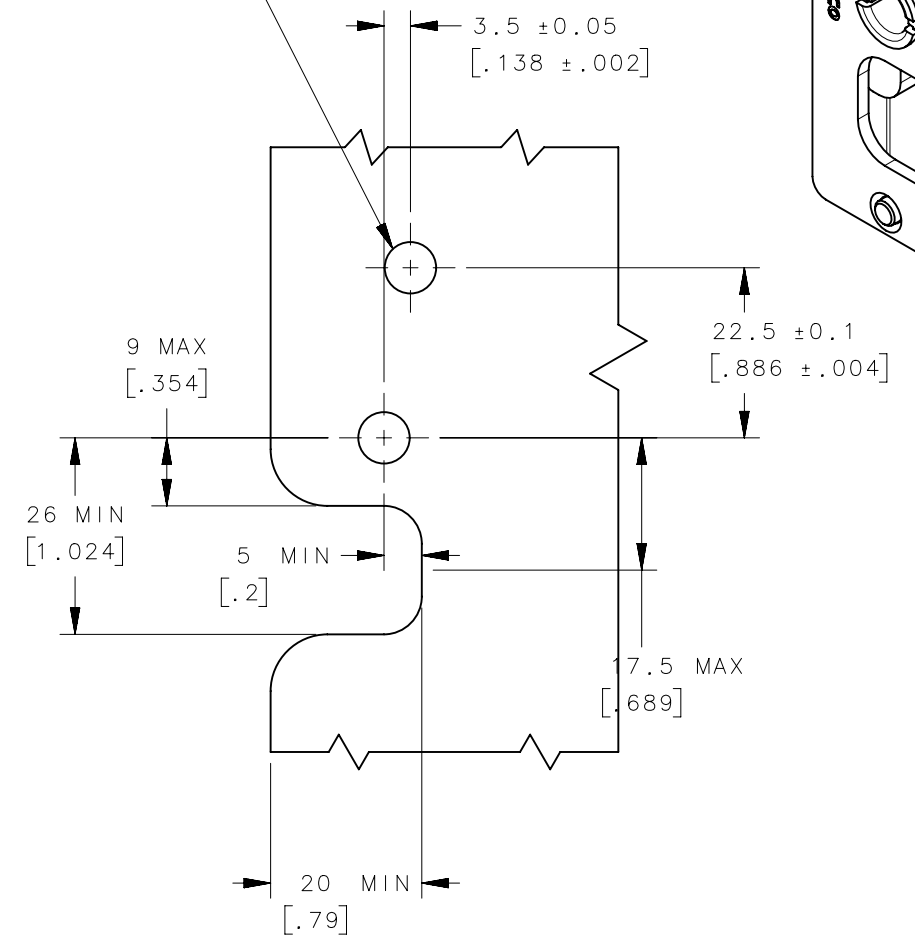
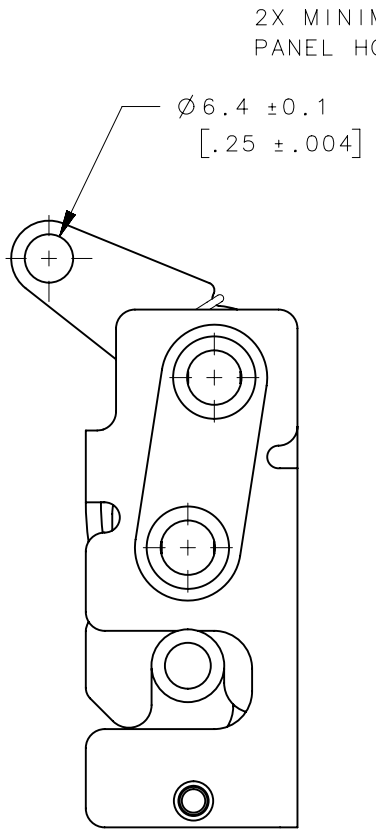
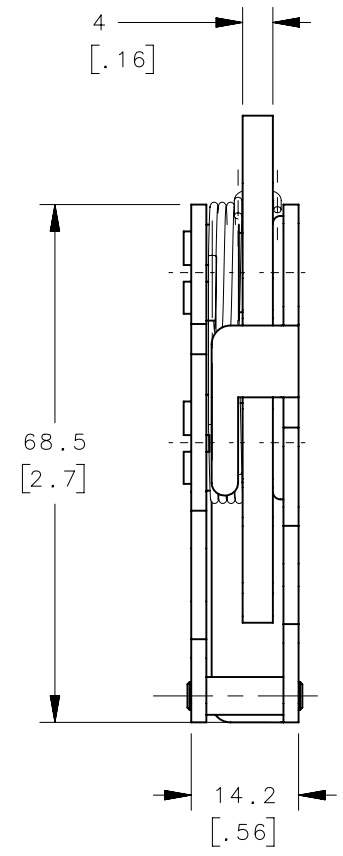
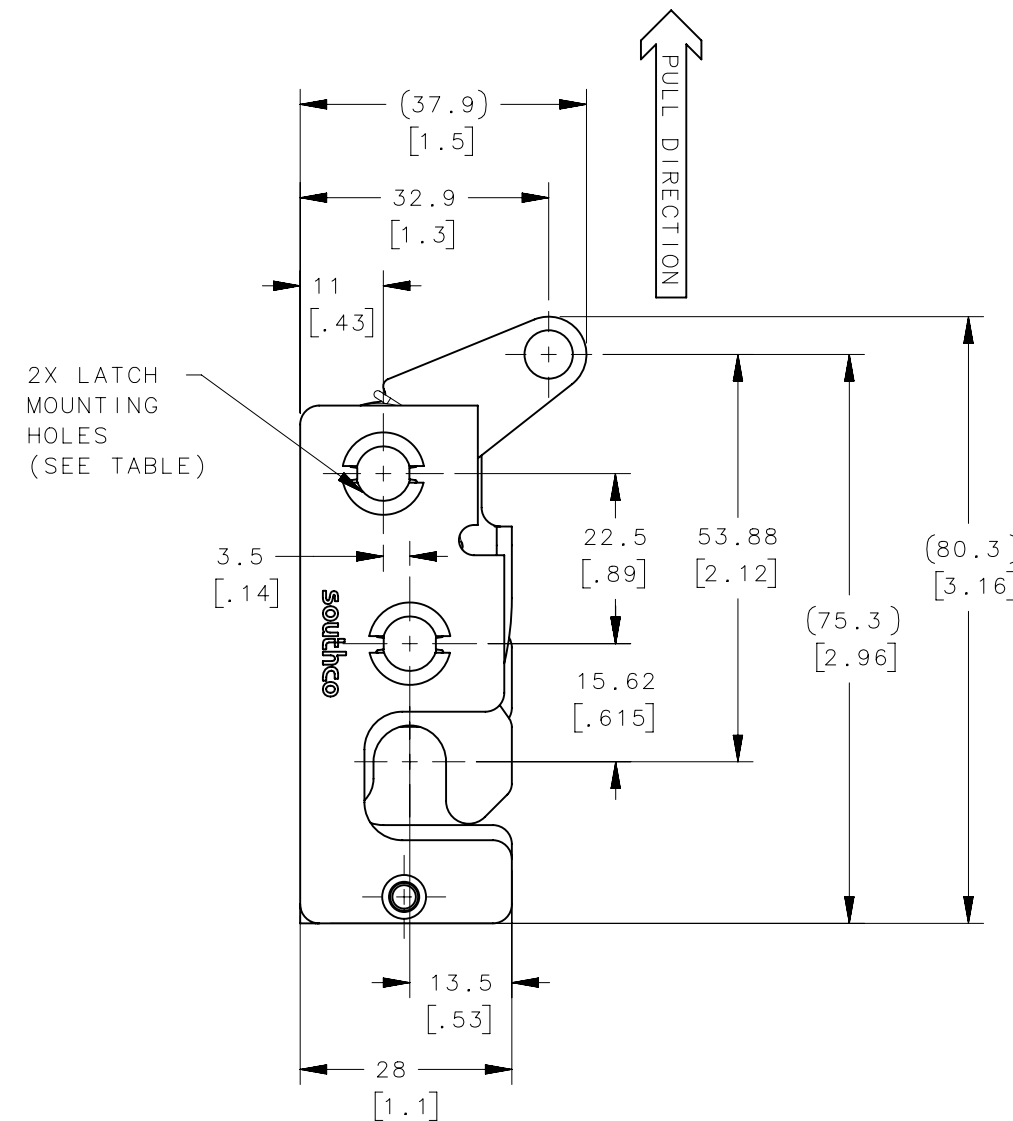

PANEL PREPARATION

ASSEMBLY R4-10-20-601-20 SHOWN

- NOTES:
- A. MATERIAL AND FINISH:
 - ALL PARTS STAINLESS STEEL.
 - B. THESE DIMENSIONS REQUIRED FOR MOUNTING STRIKER BOLT.

R4-10-20-601-20	$\varnothing 7.2\text{mm}$ THRU	$\varnothing 7.6$ [.299]	
R4-10-21-601-20	1/4-20 THREAD	$\varnothing 6.8$ [.268]	
R4-10-22-601-20	M6 THREAD	$\varnothing 6.4$ [.252]	
ASSEMBLY PART NUMBER	LATCH MOUNTING HOLE	MINIMUM RECOMMENDED PANEL HOLE	GENERAL NOTES
	THIRD ANGLE PROJECTION		
	MILLIMETERS [IN]		
SURFACE AREA	TOLERANCES UNLESS OTHERWISE NOTED		southco [®] CONNECT • CREATE • INNOVATE
VOLUME	ALL DIMENSIONS WITHOUT TOLERANCES ARE FOR REFERENCE ONLY.		
PROPRIETARY ITEM	PER ASME Y14.5M-1994	DESCRIPTION	R4 STAINLESS STEEL MINI ROTARY LATCH WITH TRIGGER HOLE - LEFT HAND
EXCEPT FOR USES EXPRESSLY GRANTED IN WRITING, INFORMATION DISCLOSED HEREON IS CONFIDENTIAL AND ALL RIGHTS, PATENT AND OTHERWISE, ARE RESERVED BY SOUTHCO, INC.		SIZE	B
		SYSTEM	NX
		DWG NO.	J-R4-10-20-601-20
		DRAWN BY	ACH/JCK
		DATE	11NOV2010
		SCALE	1:1
		SHEET	1 OF 3

6

5

4

3

2

1

6

5

4

3

2

1

REVISION HISTORY			
REV	DATE	BY	DESCRIPTION
C	11MAY2011	ACH/JCK	PRN: P2011-0543

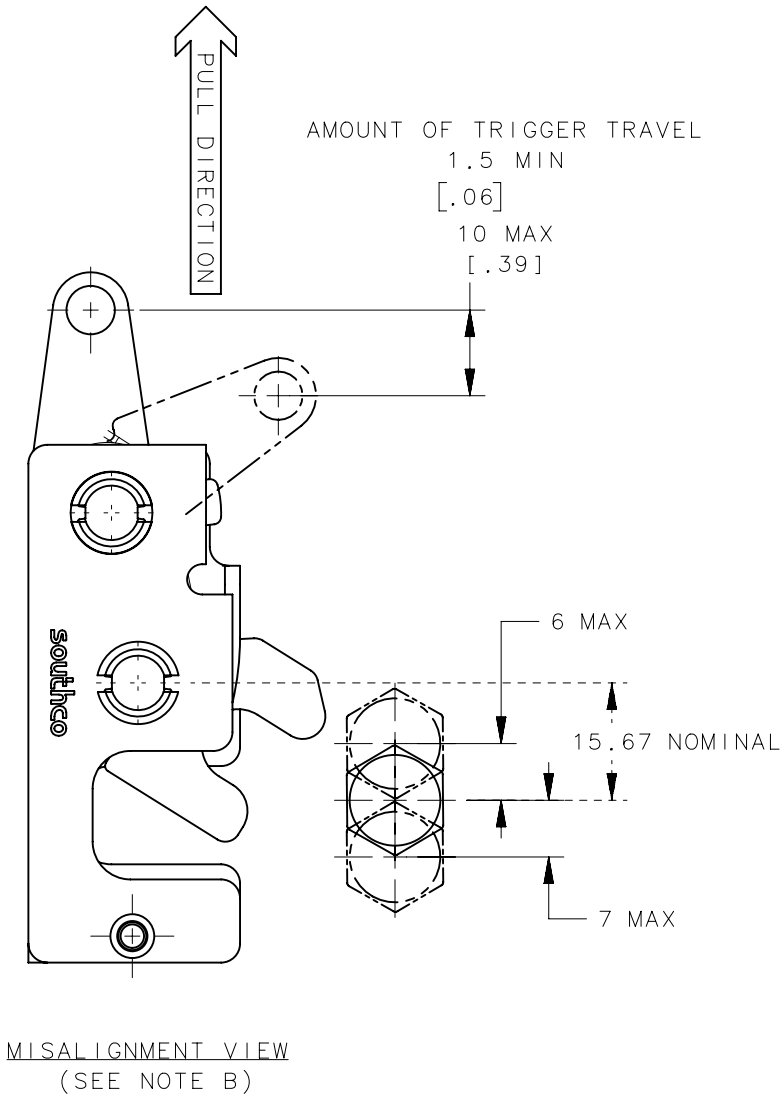
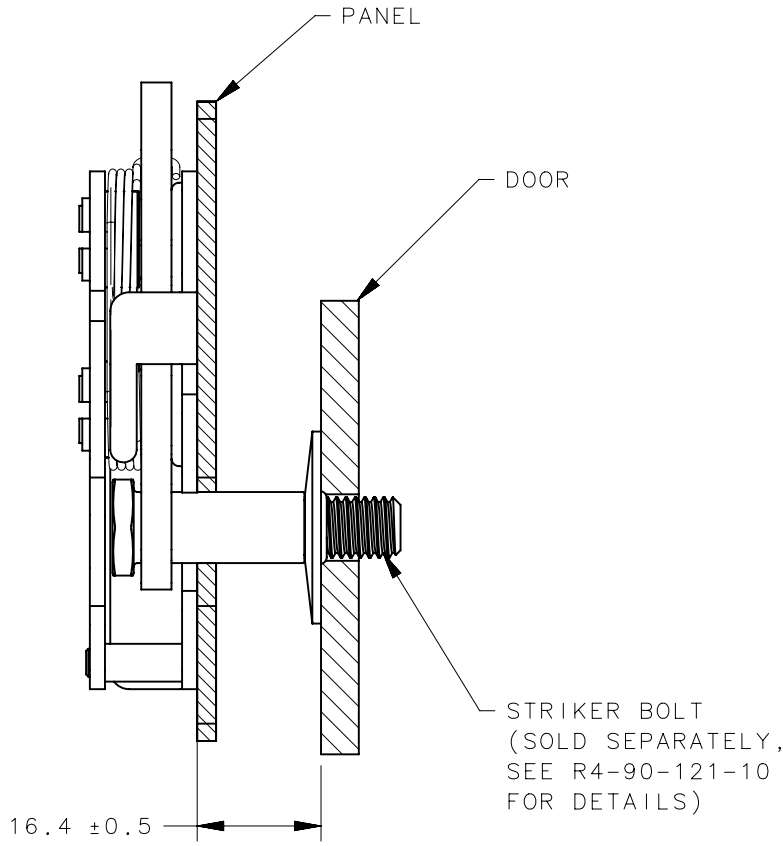
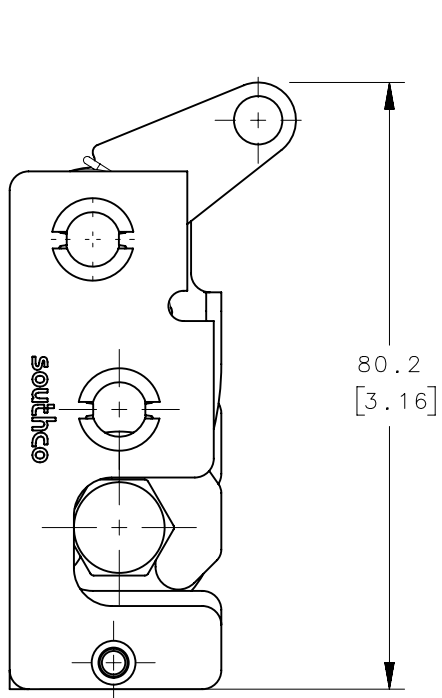

ASSEMBLY R4-10-20-601-20 SHOWN

NOTES:

- A. THE TOLERANCE BETWEEN THE LATCH AND STRIKER BOLT ASSUMES A NON-RIGID DOOR INSTALLATION THAT WILL ALLOW THE DOOR TO MOVE INTO THE NOMINAL POSITION DURING LATCHING. RIGID DOORS MUST HAVE THE STRIKER INSTALLED PER THE PANEL PREPARATION RECOMMENDATION.
- B. THE MISALIGNMENT VIEW ASSUMES THE LATCH IS CONNECTED TO A PERFECTLY RIGID DOOR AND HINGE; THEREFORE, THERE IS NO DOOR AND/OR HINGE SLACK ASSOCIATED WITH THESE DIMENSIONS. THE MISALIGNMENT VIEW DOES NOT TAKE FLEXING OF THE STRIKER BOLT INTO ACCOUNT.

R4-10-20-601-20	Ø 7.2mm THRU	Ø 7.6 [.299]	
R4-10-21-601-20	1/4-20 THREAD	Ø 6.8 [.268]	
R4-10-22-601-20	M6 THREAD	Ø 6.4 [.252]	
ASSEMBLY PART NUMBER	LATCH MOUNTING HOLE	MINIMUM RECOMMENDED PANEL HOLE	GENERAL NOTES
	THIRD ANGLE PROJECTION	 southco [®] CONNECT • CREATE • INNOVATE	
	MILLIMETERS [IN]		
SURFACE AREA	TOLERANCES UNLESS OTHERWISE NOTED		DESCRIPTION R4 STAINLESS STEEL MINI ROTARY LATCH WITH TRIGGER HOLE - LEFT HAND
VOLUME	ALL DIMENSIONS WITHOUT TOLERANCES ARE FOR REFERENCE ONLY.		
PROPRIETARY ITEM	PER ASME Y14.5M-1994	SIZE B	SYSTEM NX
EXCEPT FOR USES EXPRESSLY GRANTED IN WRITING, INFORMATION DISCLOSED HEREON IS CONFIDENTIAL AND ALL RIGHTS, PATENT AND OTHERWISE, ARE RESERVED BY SOUTHCO, INC.		DWG NO. J-R4-10-20-601-20	DATE 11NOV2010
		DRAWN BY ACH/JCK	SCALE 1:1
			SHEET 2 OF 3

6

5

4

3

2

1

6

5

4

3

2

1

REVISION HISTORY			
REV	DATE	BY	DESCRIPTION
C	11MAY2011	ACH/JCK	PRN: P2011-0543

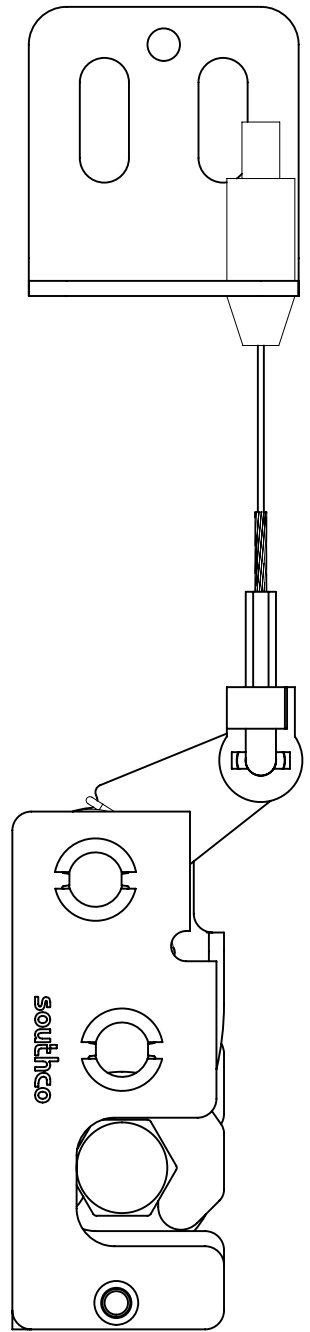
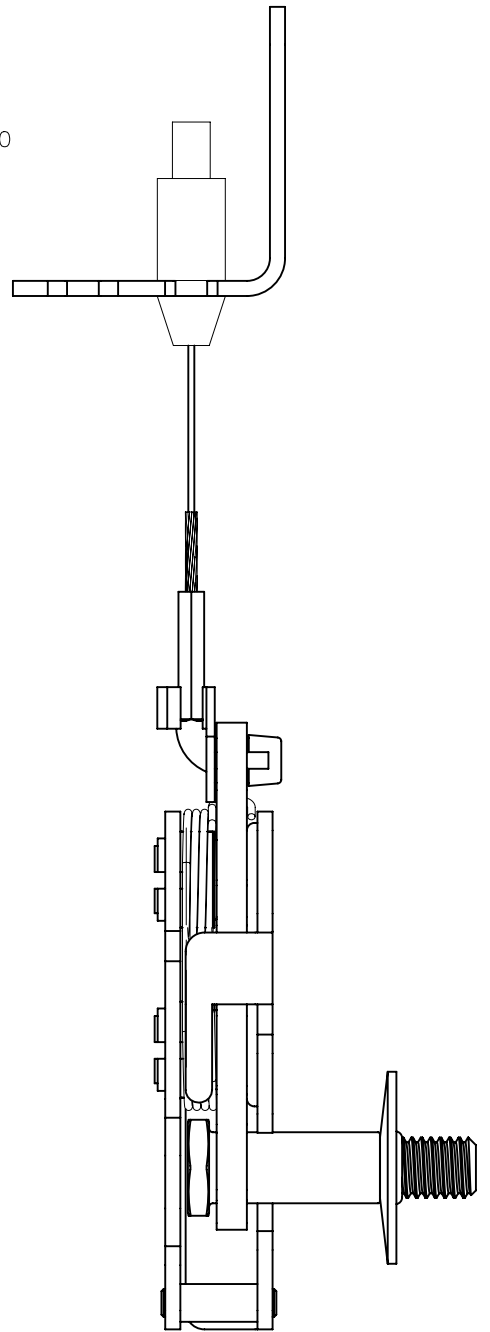
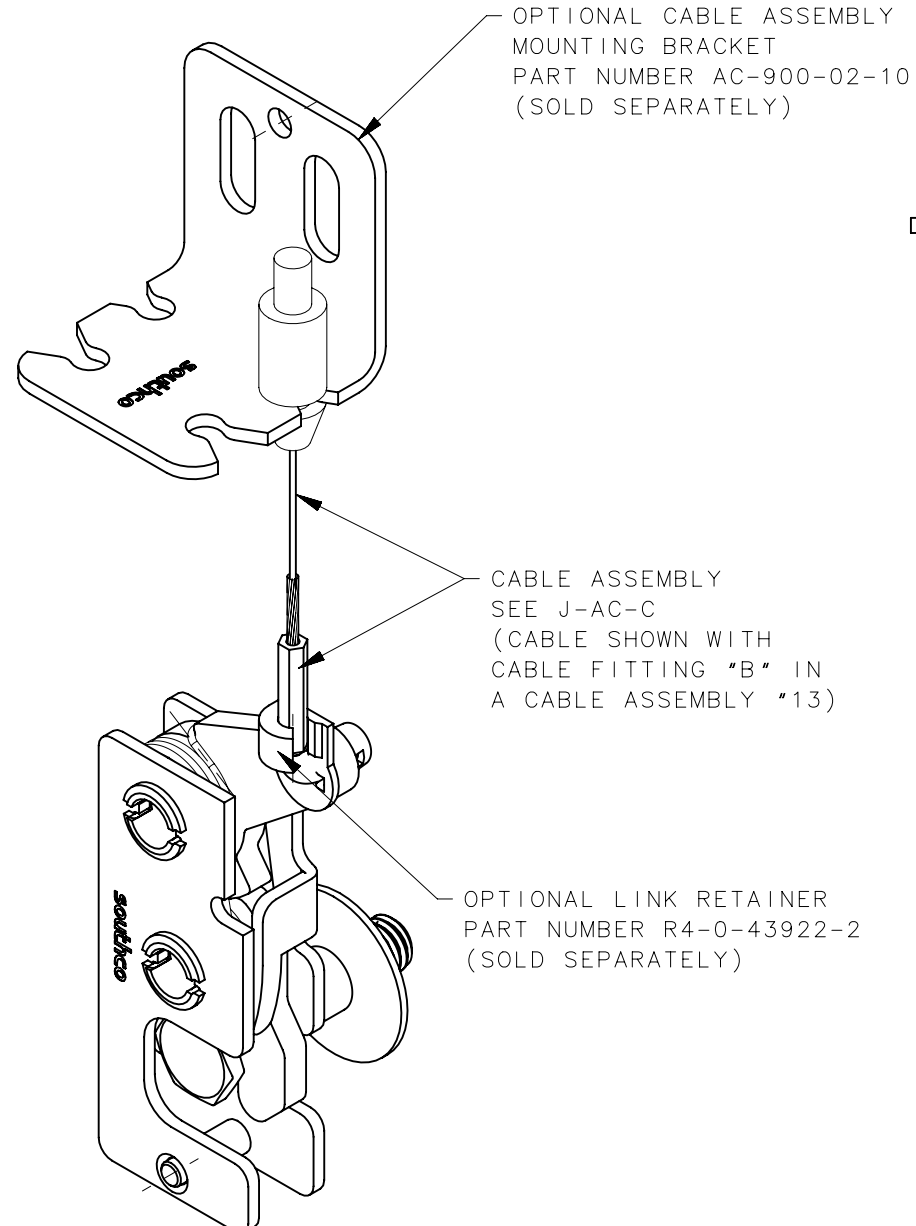

ASSEMBLY R4-10-20-601-20 SHOWN

R4-10-20-601-20	Ø 7.2mm THRU	Ø 7.6 [.299]	
R4-10-21-601-20	1/4-20 THREAD	Ø 6.8 [.268]	
R4-10-22-601-20	M6 THREAD	Ø 6.4 [.252]	
ASSEMBLY PART NUMBER	LATCH MOUNTING HOLE	MINIMUM RECOMMENDED PANEL HOLE	GENERAL NOTES

THIRD ANGLE PROJECTION				southco [®] CONNECT • CREATE • INNOVATE	
MILLIMETERS [IN]					
SURFACE AREA XXXXXmm ²		TOLERANCES UNLESS OTHERWISE NOTED		DESCRIPTION R4 STAINLESS STEEL MINI ROTARY LATCH WITH TRIGGER HOLE - LEFT HAND	
VOLUME XXXXXmm ³		ALL DIMENSIONS WITHOUT TOLERANCES ARE FOR REFERENCE ONLY.			
PROPRIETARY ITEM		SIZE B	SYSTEM NX	DWG NO. J-R4-10-20-601-20	
EXCEPT FOR USES EXPRESSLY GRANTED IN WRITING, INFORMATION DISCLOSED HEREON IS CONFIDENTIAL AND ALL RIGHTS, PATENT AND OTHERWISE, ARE RESERVED BY SOUTHCO, INC.		PER ASME Y14.5M-1994	DRAWN BY ACH/JCK	DATE 11NOV2010	SCALE 1:1
				SHEET 3 OF 3	

6

5

4

3

2

1