

REVISION HISTORY			
REV	DATE	BY	DESCRIPTION
I	24FEB2018	RKS/DMS	PRN: P2018-0481

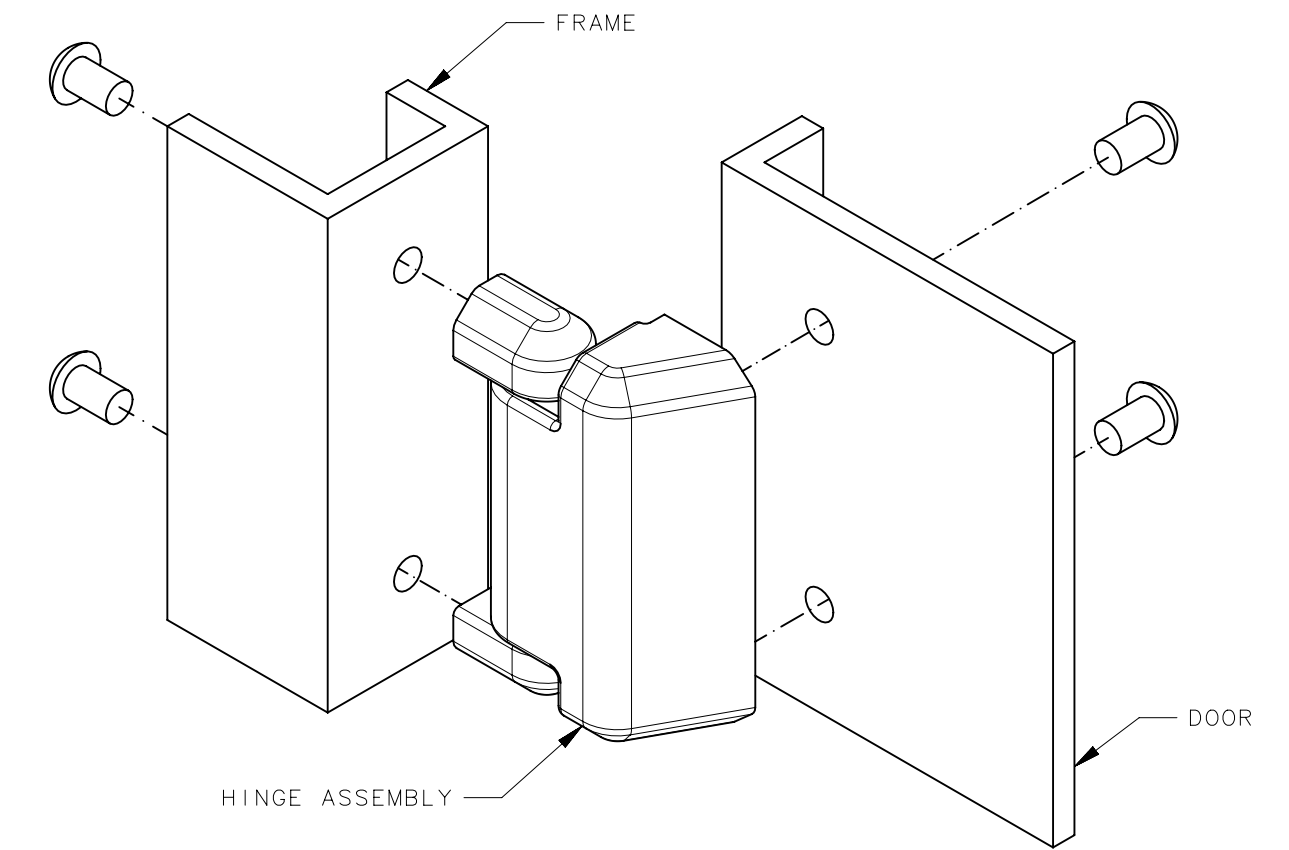

YY	FINISH
20	SATIN CHROME
50	BLACK PAINT
70	SILVER PAINT

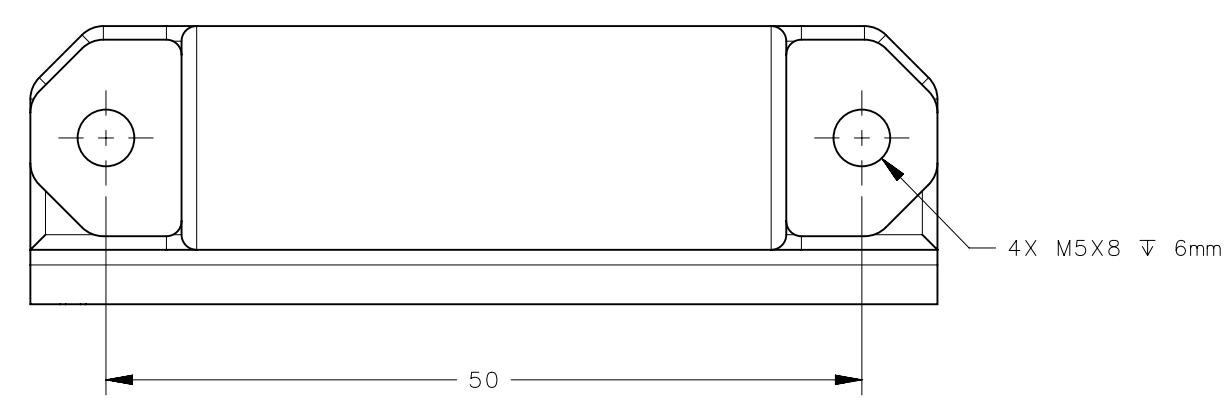
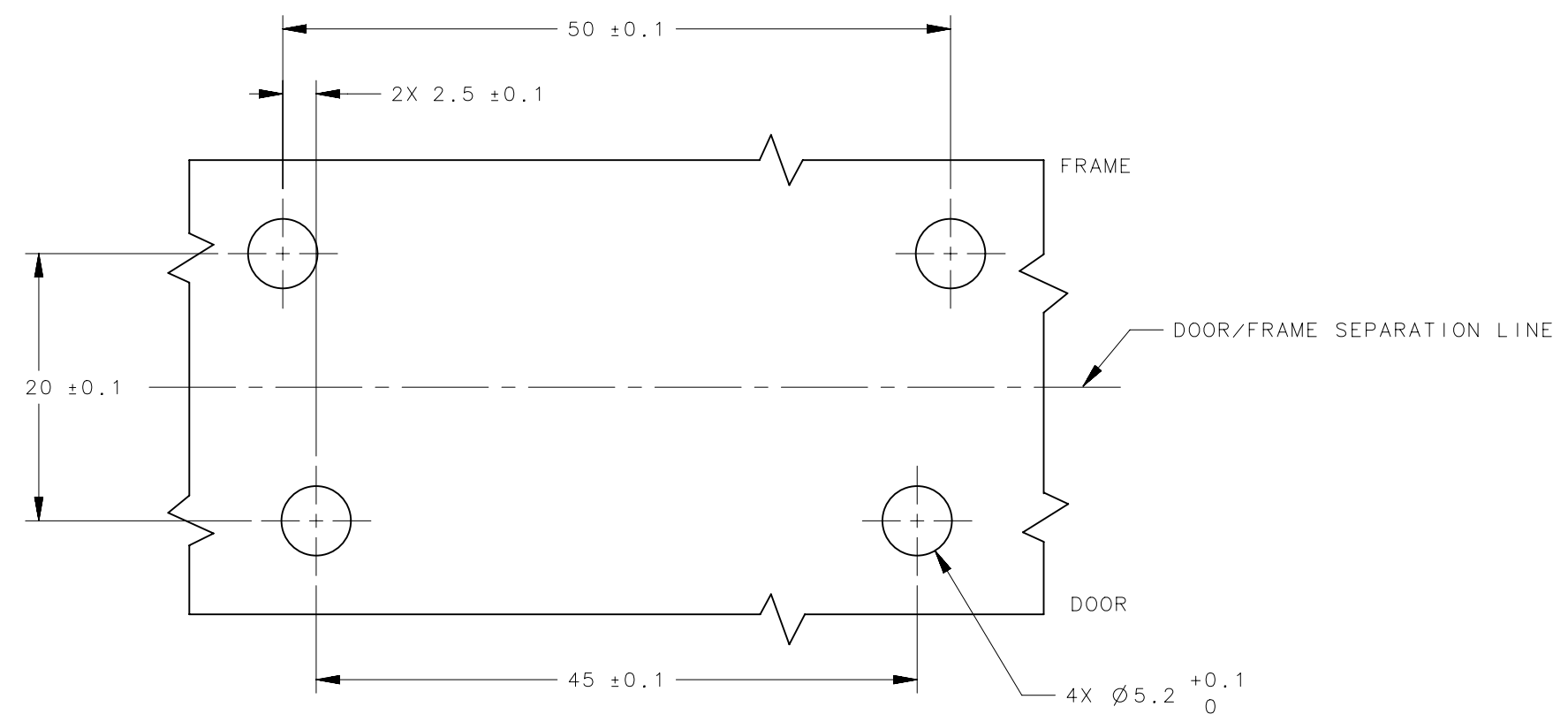
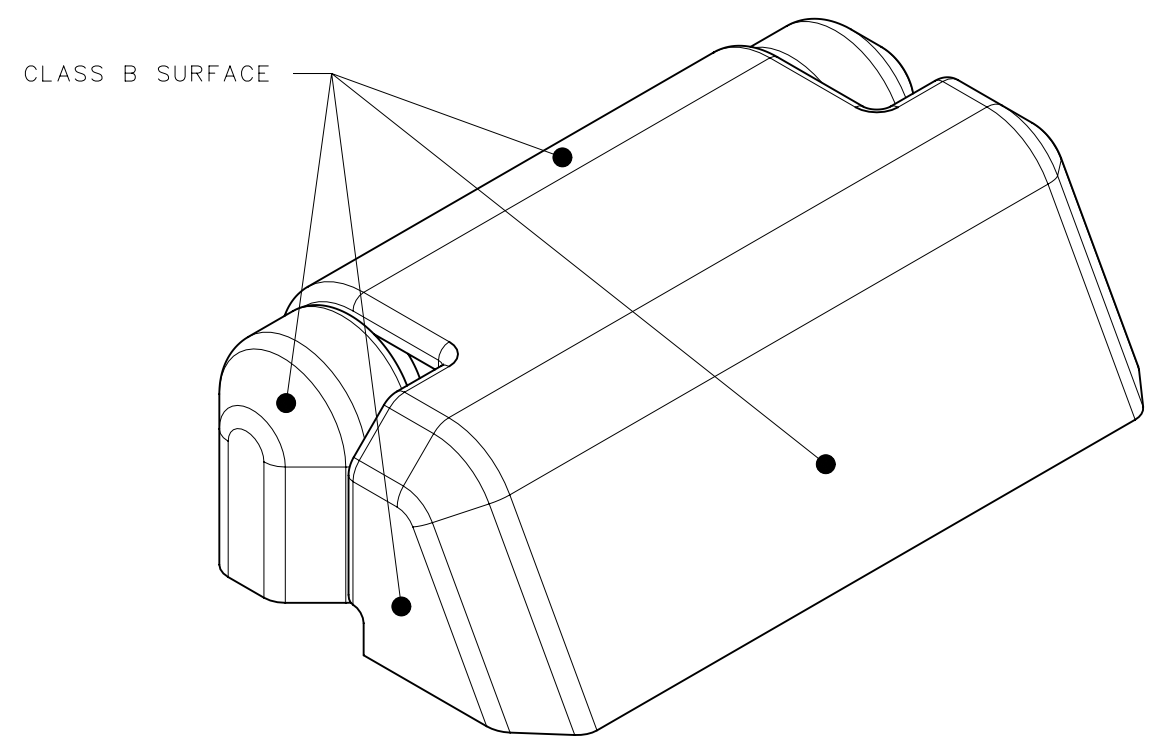
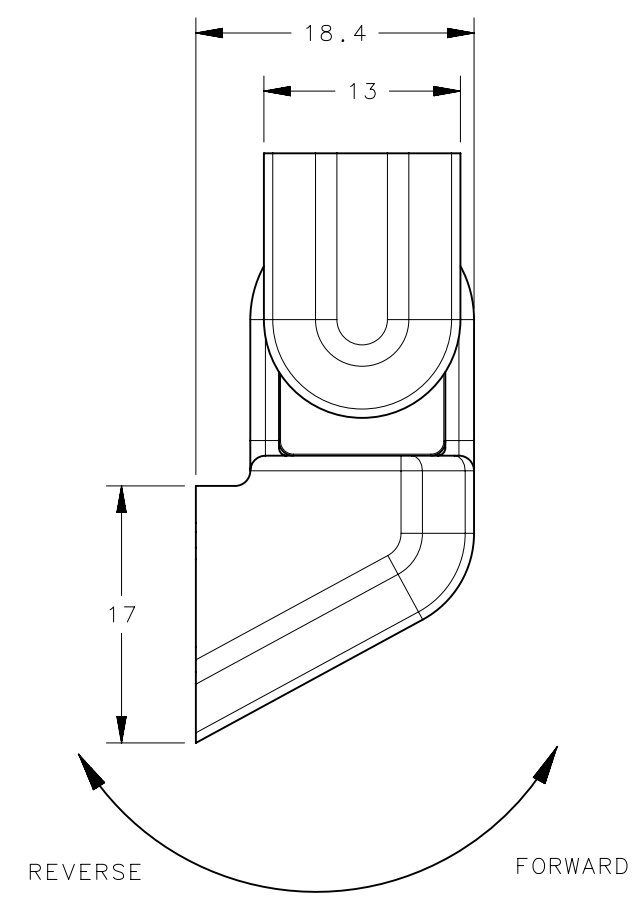
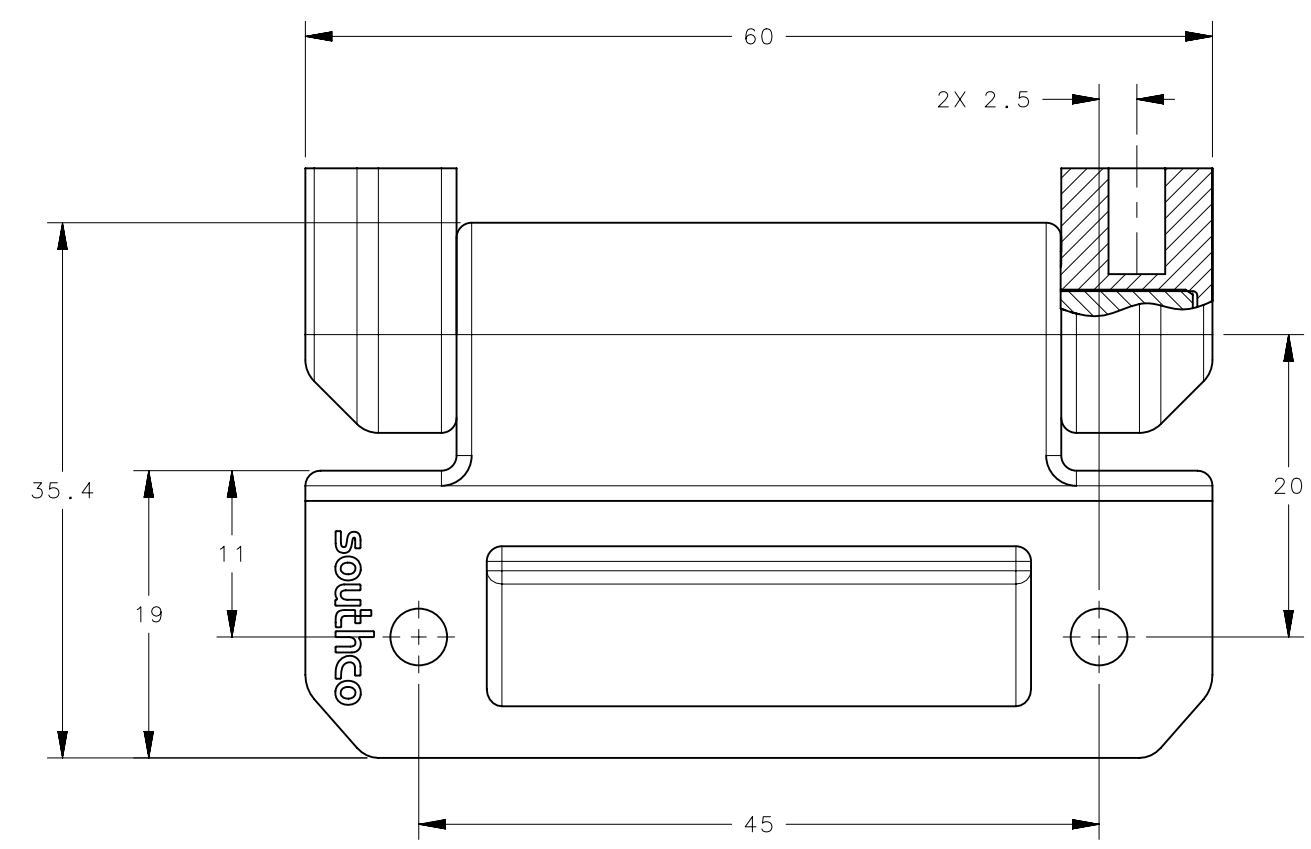

PART NO.	FORWARD TORQUE ±20% (lbf-in)	REVERSE TORQUE ±20% (lbf-in)	FORWARD TORQUE ±20% (n-m)	REVERSE TORQUE ±20% (n-m)
E6-60-400-[YY]	FREE OPERATING		FREE OPERATING	
E6-60-412S-[YY]	12			1.36
E6-60-420S-[YY]	20			2.26
E6-60-428S-[YY]	28			3.16
E6-60-436S-[YY]	36			4.07
E6-60-420F-[YY]	20	13.6	2.26	1.54
E6-60-428F-[YY]	28	19.1	3.16	2.16
E6-60-436F-[YY]	36	24.6	4.07	2.78
E6-60-444F-[YY]	44	30	4.97	3.39
E6-60-420R-[YY]	13.6	20	1.54	2.26
E6-60-428R-[YY]	19.1	28	2.16	3.16
E6-60-436R-[YY]	24.6	36	2.78	4.07
E6-60-444R-[YY]	30	44	3.39	4.97

- NOTES:
- A. OPERATION TORQUE TOLERANCE ±20%
 - B. MATERIAL AND FINISH:
HINGE BODY: ZINC ALLOY, SEE TABLE FOR FINISH.
O-RING: BUNA-N RUBBER
INTERNAL COMPONENTS: HARDENED STEEL
 - C. COSMETIC SPECIFICATION:
ALL SURFACES UNLESS OTHERWISE NOTED ARE TO CONFORM TO CLASS *C* DESIGNATION AS DESCRIBED IN SOUTHCO COSMETIC SPECIFICATION:
S-121-01 FOR SATIN CHROME

THIRD ANGLE PROJECTION		 CONNECT · CREATE · INNOVATE
MILLIMETERS [IN]		
TOLERANCES UNLESS OTHERWISE NOTED		DESCRIPTION
ALL DIMENSIONS WITHOUT TOLERANCES ARE FOR REFERENCE ONLY.		E6-60 HINGE ASSEMBLY
PROPRIETARY ITEM EXCEPT FOR USES EXPRESSLY GRANTED IN WRITING, INFORMATION DISCLOSED HEREIN IS CONFIDENTIAL AND ALL RIGHTS, PATENT AND OTHERWISE, ARE RESERVED BY SOUTHCO, INC.	SIZE C SYSTEM NX	DWG NO. J-E6-60-400
PER ASME Y14.5M-1994	DRAWN BY DZ/FV	DATE 24AUG2005 SCALE 2:1 SHEET 1 OF 1